



2010 - 2011 ANNUAL REPORT

# COMMUNITY

# THANK YOU.

To all alumni, parents, parents of alumni, grandparents, faculty, staff, and friends who gave to Rowland Hall in 2010-2011, your support of Rowland Hall's mission is greatly appreciated. Every gift makes a difference.



## ADMINISTRATION 2010 - 2011

### Head of School

Alan Sparrow

### Associate Head of School

Julie A. Barrett

### Beginning School Principal

Carol Blackwell

### Lower School Principal

Deborah Mohrman

### Assistant Lower School Principal

Margaret Rose

### Middle School Principal

Stephen Bennhoff (through June 2011)

### Middle School Dean of Students

Mary Jo Maker

### Upper School Principal

Lee Thomsen

### Assistant Upper School Principal

Ryan Hoglund

## BOARD OF TRUSTEES

Bob Steiner, Board Chair

Richard Badenhausen, Chair, Education Committee

Amy Baker

John Bird, Chair, Finance Committee

Alex Bocock

Priya Junnar Chodosh, Chair, Food Services Committee

Pastor France Davis

Tiffany Glasgow, Chair, Nominating Committee

Sam Goldstein, Chair, Diversity Committee

Linda M. Graves

Scott B Hayashi, Bishop of the Episcopal Diocese of Utah

Wally Jarman

Guy P. Kroesche

Jennifer Beck Lair, Chair, Alumni Committee

Jill Lang

Kurt Larsen

Ben Logue

Philip McCarthy, Board Vice Chair

Margaret Niver McGann, Chair, Legal Committee

Rhonda Nicoloff

Allison Paradise

Kelly Patterson

Jennifer Price-Wallin, Chair, Development Committee

Robin Puri

Ira Rubinfeld, Chair, Annual Fund

Saba Siddiqui

Shari Veverka

### Ex-Officio

Alan Sparrow, Head of School

Julie A. Barrett, Assistant Head of School

### Trustee Emeriti

Peter Billings, Jr. '63

Ian Cumming

Christopher "Kit" Sumner '64



## IT WAS A VERY GOOD YEAR

Dear Parents, Alumni, Faculty, Staff, and Friends,

What a terrific year 2010-2011 was for our Rowland Hall community. First of all, our students' achievements were outstanding! Sweeping the chess championships in all divisions and having our jazz bands win state honors at both the middle and upper school levels were very impressive accomplishments. We won four state athletic championships (the most of any school in 2A and tied with only two other schools for most in the state) and,

in spite of the horrific car accident from which all are now recovering, remarkably our Rowmark team had its best year ever. No surprise, then, that Todd Brickson was named Intermountain Ski Coach of the year!

Watching and enjoying the thrill of children learning is fun and instructive for me and there are always outstanding examples each year. Two stand out from the past school year. Several Upper School students started The Make Club (whose purpose is scientific exploration) and its members subsequently launched a space balloon that traveled to 100,000 feet, with GPS and other technological features feeding data back to earth in real time. Equally impressive was a project inaugurated by our senior class – the all-school Carnival was wildly successful for each participant and also served as a fantastic way to unite the entire school at the end of the year. The Carnival is the Class of 2011's class gift to the school, and next year's senior class is committed to continuing what will, I'm sure, prove to be a wonderful new school tradition. We appreciate all the effort and thought that went into the planning and execution of this fun family event.

Speaking of hard work, it was truly because of the efforts put in by many committed individuals that Rowland Hall has finally, officially acquired the Steiner Campus property. We have a clear vision of a new home for middle and upper school students – one that will truly be designed for the kind of learning our students will need to be successful in the future. Depending on how fund raising progresses during the early quiet

phase of the capital campaign, the new campus will be built in whole or in phases. You will hear much more about this in the near future, but clearly we can celebrate having hurdled some big obstacles thus far.

Also on the financial and fundraising fronts, our Annual Fund is strong and, because of each and every gift and donor, it continues to provide critical support for school operations. In addition Rowland Hall was honored this year to receive a \$2 million award from the prestigious, national Malone Family Foundation. This gift to our endowment will provide scholarship funding for academically talented future students. And, we have no debt. The school is in excellent financial shape.

I love to receive emails and notes from students, parents, grandparents, and alumni. So in closing, I'd like to share the words of a parent whose children were new to the school last year: "As the school year comes to an end, I have been looking back at our first year at Rowland Hall with absolute amazement and admiration. Our expectations were high. Both my wife and I graduated from highly regarded east coast prep schools. In Los Angeles, we placed our boys in an independent school with an excellent reputation. Yet, the experience our children have had over the last nine months at Rowland Hall absolutely blew those other institutions out of the water."

Thank you for allowing me to be a part of this supportive community of learners.

Sincerely,

Alan Sparrow, Head of School

### Individuals in the Class of 2011...

attended a medical summit at Johns Hopkins University; participated in an engineering camp at the University of Utah; interned in a Beirut law office; attended a nanotechnology mentorship program at the Moran Eye Center; assisted in research of an anti-convulsant drug; worked with children with systematic muscular dystrophy; coached autistic children; learned Russian, Mandarin, Arabic, Tagalog, Thai, Spanish, French, and Latin; participated in Global Works in Ecuador, People to People in Europe, and Youth for Understanding in Argentina; served communities

in the United States, Ecuador, Brazil, France and Cambodia; helped build schools for girls in Afghanistan; raised awareness of child soldiers in Uganda; taught sustainable land practices in Brazil; adopted refugee families in Utah; dedicated time locally to Habitat for Humanity, the Pingree School, the Children's Center, Shoes for Souls, Doctors Without Borders, Utah Food Bank, and Crossroads Urban Center; participated in political campaigns; initiated No Auto April and won the Green Cup Challenge video contest; testified before the Health and Human Services Committee of the

Utah Legislature; excelled in equestrian, freestyle skiing, water polo, rodeo, girls' wrestling, cycling, kayaking, road biking, skeet shooting, sailing, and snowboarding competitions; played in the Utah Youth Symphony, sang with the Cathedral of Madeleine Choir, shot and edited a film, danced in New York City, and participated in arts programs at UCLA, Oxbow, Carnegie Mellon and the University of Utah; produced SummerWorks videos; became an accomplished cook; achieved Eagle Scout status; participated in the Salt Lake City Peer Court; and trained with the National Outdoor Leadership School.



# ANNUAL REPORT

**EDITOR:** Kathy Adams

**MANAGING EDITOR:** Susan Koles

**LAYOUT/PRODUCTION:** Mason Fetzer

**EDITORIAL PHOTOS:** Kirsten Hepburn, Lifetouch,  
Stephanie Orfanakis, Michael Schoenfeld, Julie Shipman

## **DEVELOPMENT**

**Director of Development** | Libby Ellis

**Director of Alumni and Special Projects** | Reagan Tolboe

**Director of the Annual Fund** | Mary Anne Wetzel

**Development Associate** | Coral Azarian

## TABLE OF CONTENTS

5	REPORTS
10	TRUSTEE TRANSITIONS
14	CONGRATULATIONS CLASS OF 2011
23	ADVANCEMENT
29	COMMUNITY
35	ALUMNI
40	DONORS

# REPORTS

## **From the Chair of the Board of Trustees:** ARE WE THE KIND OF SCHOOL WE WANT TO BE?

“Okay, fifth graders! Take six giant steps back, all the way into Middle School!” said Deborah Mohrman at the June 8 Stepping Back Ceremony. This was the last Stepping Back I am likely to see, as our youngest child moves on to sixth grade. I will miss witnessing the thrill of the children at the beginning of summer, their sense of accomplishment for having contributed to the life of their class, their realization that they have grown, and most of all their happiness abounding. I felt the happiness of our students on that day, and then again at three subsequent commencement exercises for our seniors, eighth graders, and fifth graders. It is a continuous impression, that our Rowland Hall children experience joy in their journey, and this should give us great satisfaction.

This year I first heard the expression, “Tiger Mom.” During the graduation week, I read in the *New York Times* that some east coast parents are paying close to six figures a year for their children’s tutors, to gain a leg up applying to an Ivy League college. In a spring meeting at Rowland Hall, the admissions director of a prestigious western college told senior parents that over 25 percent of her freshman class were taking prescription medications to assist with emotional instability. Am I alone in thinking that vanity, and misplaced values, are putting too much pressure on children? We can offer an outstanding educational experience without that kind of unhealthy pressure.

At a Board of Trustees’ retreat in early November, we are planning to reflect again upon what kind of a school we want Rowland Hall to be. I will be there to say that our children are happy in their school life. I will say this is good in itself, a treasure. It is also true that years from now our children will still know what it feels like to be happy, and if they run into



some rough stretches then they might remember what is healthy and good for them. I want this most of all for my children.

To support our children’s educational passage from toddler years through high school graduation, Rowland Hall has entered the quiet phase of a capital campaign for new middle and upper school facilities on the Steiner Campus. We are assembling pledges and early gifts. We are gauging how far we can go in the next few years toward our long-term goal of building the most effective facility in this country for learning. We do not know all the answers yet.

Please be thinking and sharing with us about how you can help. I think Rowland Hall serves our children very well, but I think we can be even better for them.

Sincerely,  
Bob Steiner

  
Board Chair

## 2010 - 2011 FINANCE REPORT



It is with pleasure that the Finance Committee of the Board of Trustees reports another successful year for our school. Rowland Hall enters the 2011-2012 year debt-free and with a funded contingency account to cushion us in the event of unanticipated financial problems.

Guided by the full Board of Trustees and the school's administrators, our committee has focused funding on critical mission-based areas of the budget. However, as tuition-paying parents we also understand that enrolling our children at the school is a financial commitment not taken lightly. Hence we have worked with the administration to identify operations at the school where, with creative adjustments, we can be more cost effective.

Tuition is our largest source of revenue and total tuition dollars is the product of tuition rate and total enrollment. While enrollment remains strong we cannot take this for granted, particularly in our current economic environment. When you refer your friends, neighbors, relatives, and colleagues to Rowland Hall you are serving a vital component of our financial stability.

The Annual Fund is the second largest funding source for the school; it provides approximately \$800 per student to make ends meet over and above tuition revenue. Your generosity to the Annual Fund keeps tuition from rising at higher percentages. Thank you to all who contribute to the Annual Fund. Many foundations, when considering making a grant to Rowland Hall, look closely at the percentage of parents participating in the Annual Fund. In addition, 100% of our faculty and staff give to the Annual Fund each year. To those of you who have yet to contribute, please consider the need and give a gift this year.

The coming year will provide challenges and opportunities for our school. The administration, Board of Trustees, and the Finance Committee won't lose sight of the importance of providing an excellent education today while maintaining the stability of the school in the years to come.

### **John Bird**

Chair, Board of Trustees Finance Committee

## 2010-2011 FINANCIAL STATEMENT

INCOME	<u>Year to Date</u>	<u>% of Budget</u>
OPERATING REVENUE		
Tuition	\$14,297,514	78.5%
Auxiliary Income	\$2,259,680	12.4%
Fees & Miscellaneous Income	\$519,654	2.9%
<b>TOTAL OPERATING REVENUE</b>	<b>\$17,076,848</b>	<b>93.8%</b>
NON-OPERATING REVENUE		
Donations	\$842,642	4.6%
Interest/Dividends	\$291,904	1.6%
<b>TOTAL NON-OPERATING REVENUE</b>	<b>\$1,134,546</b>	<b>6.2%</b>
<b>TOTAL INCOME</b>	<b>\$18,211,394</b>	
EXPENSES/TRANSFERS		
Instructional	\$9,488,113	52.1%
Administrative and General	\$1,456,968	8%
Building and Grounds	\$990,143	5.4%
Development	\$474,644	2.6%
Marketing and Communications	\$297,198	1.6%
Library	\$20,374	0.1%
Auxiliary Services	\$2,505,431	13.8%
Technology	\$748,718	4.1%
Scholarships and Financial Aid	\$1,427,567	7.8%
Transfer to Plant Account	\$667,510	3.7%
Miscellaneous Expenses	\$131,185	0.7%
<b>TOTAL EXPENSES</b>	<b>\$18,207,851</b>	
<b>NET SURPLUS (DEFICIT)</b>	<b>\$3,543</b>	

*These numbers are audited each year in August after the Annual Report press deadline. Historically, very few changes are required as a result of the annual financial audit.*

FOR THE YEAR ENDED  
JUNE 30, 2011



REVENUE

- Tuition and Fees - 82.5%
- Annual Fund - 4.2%
- Auxiliary Services - 10.9%
- Interest - 0.8%
- Misc. Activities - 1.5%



EXPENSES

- Salaries, Benefits and Taxes - 64.5%
- Plant Repairs and Bus Replacement - 2.4%
- Instructional - 11.3%
- Maintenance and Utilities - 3.7%
- Scholarships and Financial Aid - 7.9%
- Administrative and Misc. - 3.3%
- Development - 0.4%
- Marketing and Communications - 0.8%
- Support / Auxiliary Services - 5.6%

COST OF EDUCATING A ROWLAND HALL STUDENT

Average Cost Per Student: **\$18,413**  
 Average Tuition Per Student: **\$14,510**  
 Percentage of Cost Paid by Tuition: **78.8%**



## TRUSTEE TRANSITIONS

*Each year the school bids farewell to individuals who have served terms on the Rowland Hall Board of Trustees. Their service was of great help and will be long remembered.*

*This year we extend a thank you to Guy Kroesche, Jennifer Beck Lair, Allison Paradise, Wally Jarman, and Robin Puri.*

**Guy Kroesche** served for eight years and was instrumental in the legal effort needed to obtain the Steiner Campus property. Guy successfully navigated the complicated project and donated hundreds of hours of legal advice and activities to bring it to a successful conclusion. He and his wife, Carol, were also the chairs of the 2008 Rowland Hall Auction. In addition, Guy served as the chair of the legal committee for the Board and on numerous committees benefiting the schools endeavors. Thank you, Guy!

**Jennifer Beck Lair**, graduate of the Class of 1989, chaired the alumni committee for three years and worked hard to enlarge the activities of our growing alumni community. She served on the finance and nominating committees and was a constant voice of support for our faculty.

**Allison Paradise**, as the Home and School representative to the Board for the McCarthy Campus, worked hard on the education committee and finance committee and put her heart into every effort she lead or championed.

**Wally Jarman**, for six years, voiced his support for sustainable philosophies and green design on the Steiner Campus project. He played a major role in the selection of project architects and the overall concept of the new campus.

**Robin Puri**, for six years, brought detailed organization and flair to many projects. She chaired the Annual Fund with her husband, Raj, and subsequently chaired the solicitations committee for the 2008 Auction. Robin was a calm force on the Board who brought insight and hard work to every project she took on.

Thanks to all of our outgoing trustees for their hard work and dedication to the school. All of our students and alumni benefited from your efforts!



*Guy Kroesche*



*Jennifer Beck Lair '89*



*Allison Paradise*



*Wally Jarman*



*Robin Puri*



## WELCOME NEW TRUSTEES

### **Akemi Takei Louchheim**

Akemi Takei Louchheim was born and raised in Los Angeles. She holds a bachelor's degree in political science from the University of California at Berkeley, a master's degree in broadcast journalism from Northwestern University, and a second master's in sports administration from Seattle Pacific University. Akemi's 20-year sports broadcasting career includes coverage of the Super Bowl, the NBA Finals, the Major League Baseball playoffs and the Final Four among other highlights. Akemi was most recently the radio sideline reporter for the Seattle Seahawks of the NFL and a sports anchor and reporter for the NBC affiliate in Seattle. She can also be heard as the sideline reporter on The XBOX's NBA Jam games. Akemi has served on the boards of the YWCA of Seattle and of her children's preschool in Seattle. She and her husband, David, moved to Park City in 2008. They have two children. Carter will be in fourth grade and Arden in first grade at Rowland Hall this fall.

### **Rachel Sweet-Martin**

Rachel Sweet-Martin was born and raised in Salt Lake City, and graduated from Rowland Hall in 1988. She earned undergraduate degrees in political science and German from Santa Clara University, and a MBA from the University of Utah. She began her professional life as an executive assistant to Representative Anna Eshoo (California) in Washington, D.C. Later, Rachel changed careers, coming back to Salt Lake as a fourth-generation candy maker at the Sweet Candy Company. She is currently Sweet's Vice President of Marketing. Rachel has volunteered on a number of boards including the Western Candy Conference, the Coalition for Utah's Future, the David Eccles School of Business, the Salt Lake Acting Company, and the Utah Manufacturers' Association. More recently, she served as room representative for Rowland Hall's 3PreK class and as a parent liaison for the Annual Fund. Rachel is married to Scott Martin, a Salt Lake attorney. They have three children all attending Rowland Hall's Beginning School: Leo, entering kindergarten, and twins Nina and Beatrice (Bea), entering 4PreK. Rachel runs, bikes, skis, and especially enjoys spending time outdoors with her husband and children.



### **John C. McNamara, II**

John C. McNamara, II is the chief executive officer of Stewart Capital, LLC, a privately held investment company based in New Orleans, Louisiana, with commercial real estate holdings throughout the United States. Since 1996, John has managed all of the company's partnerships and oversees all aspects of its operations and investments. He is also co-founder and general partner of LongueVue Capital, LLC ("LVC"), a value-oriented private equity company focused on debt and equity investments in middle market companies. Since 2000, John has been involved in the operational and financial leadership of LVC. Prior to 1996, John served as an investment banker at Drexel Burnham Lambert and Donaldson Lufkin & Jenrette, and as a turn-around operating executive with Heico Acquisitions. John received his bachelor's degree in finance from Georgetown University and his MBA from Harvard Business School. (While at Georgetown, he was a three year starter on the varsity tennis team and a finalist in the NCAA Big East Singles Championship in 1986). John has served in leadership positions for a number of business, civic, academic, community, and non-profit organizations. John is married to Adrienne Yarlett McNamara and since the family moved from New Orleans to Park City in 2007, they have both been actively involved in the Rowland Hall community. John has served on Rowland Hall's Capital Campaign Steering Committee since its inception. John and Adrienne's children, Will and Molly, will attend Rowland Hall's Middle School and Lower School, respectively, in the fall of 2011.



### **Brian Barker**

Brian Barker grew up in Ogden, Utah, and attended St. Joseph elementary and high school. He graduated from the University of Utah School of Pharmacy and completed a residency in hospital pharmacy at the New Mexico Federal Medical Center. For five summers during college, Brian worked for the United States Forest Service on helicopter attack fire crews, and as a smoke jumper based in Redmond, Oregon. In 1992 Brian returned to Utah to accept a job as a critical care pharmacist at the University of Utah Medical Center, and has worked there for the last 17 years. Brian and his wife Karey met at the U and their four children Jessica, Madison, Elena, and Brandt attend Rowland Hall. Brian loves to ski, take photographs, coach soccer, and spend time hiking.





### **Josh Kanter**

Josh Kanter is president of Chicago Investments, Inc. and vice-president of Windy City, Inc., closely held investment management firms and also serves as vice-president and a director of the Kanter Family Foundation, a not-for-profit private charitable foundation. In addition, Josh is president and a director of Art Enterprises, Ltd., owner of a contemporary art collection, and counsel to the Chicago law firm, Barack, Ferrazzano, Kirschbaum & Nagelberg specializing in securities and corporate and real estate law. He is currently a member of the board of trustees of the Salt Lake Art Center, the 337 Project, and the International Sculpture Center, publisher of *Sculpture* magazine. He is a member of the Young Benefactors Council at the Utah Museum of Fine Arts, is a member of the Temple Har Shalom art committee, and is a member of the Art Chicago Host Committee. Josh has participated in a number of art selection committees for public art projects around Salt Lake City including projects for the Salt Palace, the David Eccles School of Business, and the Utah Museum of Natural History. In 2010, Josh co-chaired the Corroon for Governor finance committee and he recently founded the Alliance for a Better UTAH. Josh graduated from Emory University in 1984 and received his J.D. from the University of Chicago Law School in 1987. Josh and his wife, Catherine, moved to Salt Lake City in 2002, and live in Sandy with their two children, Nate and Benjamin, who will attend Rowland Hall's Beginning School and Lower School respectively in fall 2011.

CLASS OF 2011



## GRADUATES OF THE CLASS OF 2011

The 63 members of the Class of 2011 clearly understood the college counseling office's philosophy that college choice is first and foremost about the fit between institution and student. We congratulate them as they successfully completed the college admission process and will matriculate this fall into 42 institutions around the country as well as several international schools. This class has the highest percentage of Rowmark Ski Academy graduates of any class in Rowland Hall history and many of these elite athletes have chosen to pursue further ski training as Rowmark post-graduates in preparation for Division 1 college programs or the

U.S. Ski Team. This year, as in previous years, more than half of our senior class received offers of merit scholarships to colleges. All our seniors made choices based on their interests and will end up at schools such as Stanford, the University of Utah, Cornell, Scripps, Massachusetts Institute of Technology, Colorado College of Mines, Georgetown, Westminster, Bates – just to name a few.

*What follows is a list of the colleges and universities to which our graduates will matriculate, then a list of the schools to which our graduates were admitted.*

## COLLEGE PLANS OF THE CLASS OF 2011

**Eric Albee §**  
Honors College  
University of Utah  
Salt Lake City, Utah

**Max Samuel Axelrod \***  
Boston College  
Chestnut Hill, Massachusetts

**Laurent Christopher Backman §**  
Actor Training Program  
University of Utah  
Salt Lake City, Utah

**Ashley Jean Bostrom §**  
University of Utah  
Salt Lake City, Utah

**Nicholas Najeeb Bradley**  
Loyola University  
New Orleans, Louisiana

**Daniel Flynn Howard Bynum §**  
St. Olaf College  
Northfield, Minnesota

**Gavin William Carmichael**  
Westminster College  
Salt Lake City, Utah

**Saja Junnar Chodosh §**  
Washington University  
St. Louis, Missouri

**Daniel J. Christensen §**  
Honors College  
University of Utah  
Salt Lake City, Utah

**James J. Cleason \***  
University of Utah  
Salt Lake City, Utah

**Patrick Hart Crompton §**  
Honors College  
University of Utah  
Salt Lake City, Utah

**Claire Frances Edgley \***  
Carleton College  
Northfield, Minnesota

**Nicholas J. Esparza §**  
Westminster College  
Salt Lake City, Utah

**Alexi Janney Fitch**  
American University  
Washington, D.C.

**George Marsh Flint IV**  
University of Edinburgh  
Edinburgh, Scotland, UK

**Michael Hall-Snyder**  
Stanford University  
Stanford, California

**Colby Hartman**  
Arizona State University  
Tempe, Arizona

**Alexandra Phillips Henderson**  
Seattle University  
Seattle, Washington

**Claire Hoffmann**  
Westminster College  
Salt Lake City, Utah

**Joseph Marken Illingworth §**  
Honors in Engineering Program  
University of Utah  
Salt Lake City, Utah

**Chloe Elizabeth Jones §**  
Wesleyan University  
Middletown, Connecticut

**Christopher Holladay Jones**  
California Polytechnic State University  
San Luis Obispo, California

**Kristie C. Kent \***  
Colorado School of Mines  
Golden, Colorado

**Alexander Hayes Kim**  
Honors Program  
University of Utah  
Salt Lake City, Utah

**Andrew Kircher**  
Postgraduate Year  
Rowmark Ski Academy

**Robert Paul Lainhart**  
San Diego State University  
San Diego, California

**Serra Nicole Lakomski**  
Chapman University  
Orange, California

**Philip James Layfield §**  
Walsh School of Foreign Service  
Georgetown University  
Washington, D.C.

**Rebecca Liou**  
Maryland Institute College of Art  
Baltimore, Maryland

**Anna Louise Loughridge \***  
Scripps College  
Claremont, California

**Wajdi Mallat**  
University of Michigan  
Ann Arbor, Michigan

**Kotchaphorn Mangkalaphiban**  
Wilson College  
Chambersburg, Pennsylvania



*Lauren Samuels, Chase Ryan, Andrew Rutledge*



*Eileen Veghte, Serra Lakoniki, Chloe Jones*

**David Maxwell Martin §**  
Montana State University  
Bozeman, Montana

**Iris Carlisle Masaryk**  
Weber State University  
Ogden, Utah

**Steven J. McCarthy**  
Trinity University  
San Antonio, Texas

**Hannah Rose Midget §**  
Whitman College  
Walla Walla, Washington

**Abigail Rose Mitchell**  
Emily Carr University of Art + Design  
Vancouver, British Columbia, Canada

**Adrienne Rose Murphy §**  
School of Hotel Administration  
Cornell University  
Ithaca, New York

**Abigail Christine Nash §**  
University of Portland  
Portland, Oregon

**Sean Ryan North §**  
Brigham Young University  
Provo, Utah

**Andrew Ian Oster**  
Southern Oregon University  
Ashland, Oregon

**Samuel Johnson Prystas Parker §**  
Otterbein University  
Westerville, Ohio

**Tara Patel §**  
University of Puget Sound  
Tacoma, Washington

**Courtney Elizabeth Reed §**  
Davidson College  
Davidson, North Carolina

**Kaitlyn Ford Rodriguez**  
St. Olaf College  
Northfield, Minnesota

**Andrew Rutledge \***  
Postgraduate Year  
Rowmark Ski Academy

**Timothy Chase Ryan \***  
Postgraduate Year  
Rowmark Ski Academy

**Lauren Elizabeth Samuels \***  
Postgraduate Year  
Rowmark Ski Academy

**Mathias McDonald Sanyer §**  
Whitman College  
Walla Walla, Washington

**Sarah Elizabeth Slusher**  
University of Utah  
Salt Lake City, Utah

**Beau Patrick Sperry §**  
Bates College  
Lewiston, Maine

**Corin Dean Thummel §**  
Whitman College  
Walla Walla, Washington

**Randy Paul Towner**  
University of Utah  
Salt Lake City, Utah

**Eileen McGrath Veghte**  
Muhlenberg College  
Allentown, Pennsylvania

**Wesley Shannon Warner §**  
Bates College  
Lewiston, Maine

**Hans Ashforth Wiener**  
Trinity College  
Hartford, Connecticut

**Zoe Cari Wolcott §**  
Wesleyan University  
Middletown, Connecticut

**Joshua Daniel Wolf §**  
Evergreen State College  
Olympia, Washington

**Carolyn Austin Wozniak §**  
Massachusetts Institute of Technology  
Cambridge, Massachusetts

**Zachariah Lee Young \***  
College of Idaho  
Caldwell, Idaho

**Ediva Medinah Zanker §**  
Syracuse University  
Syracuse, New York

**Linnea Joy Zavala \***  
Whitworth University  
Spokane, Washington

**Hannah Cheng Zhou §**  
Trinity University  
San Antonio, Texas

**Nathan Zick-Smith §**  
Honors College  
University of Colorado  
Boulder, Colorado

§ Denotes World Language Award granted to students who complete four successive years of study in one foreign language having earned no Fs and no more than one D in 12 trimesters

\* Plans to defer college matriculation until Fall 2012.



*Linnea Zavala, Salutatorian*

*The following colleges and universities offered admission to one or more members of Rowland Hall's Class of 2011.*

University of Alabama	Emory University	Rensselaer Polytechnic Institute
University of Alaska	Evergreen State College	Rochester Institute of Technology
Allegheny College	Ft. Lewis College	University of Rochester
American University	Georgetown University	Rose-Hulman Institute of Technology
Arizona State University	Gustavus Adolphus College	Saint Mary's College
Baldwin-Wallace College	Heriot-Watt University, Edinburgh, Scotland	Saint Michael's College
Bard College	Humboldt State University	San Diego State University
Bates College	Ithaca College	University of San Francisco
Bennington College	James Madison University	Santa Clara University
Boston College	Kalamazoo College	Savannah College of Art and Design
Boston University	Knox College	Scripps College
Brigham Young University	Lake Forest College	Seattle University
California Institute of Technology	Lewis & Clark College	Sierra Nevada College
University of California, Davis	Linfield College	Simmons College
University of California, Santa Barbara	Loyola University, New Orleans	Skidmore College
University of California, Santa Cruz	University College London	Smith College
California College of the Arts	Loughborough University, England	Southern Oregon University
California Lutheran University	Luther College	Southern Utah University
California Polytechnic State University	Maryland Institute College of Art	St. Lawrence University
California State University	Massachusetts Institute of Technology	St. Olaf College
Carleton College	McGill University, Montreal	Stanford University
Chapman University	Menlo College	University of Surrey, England
College of Charleston	University of Miami	Syracuse University
Clark University	University of Michigan	Trinity College, CT
Colby College	Montana State University	Trinity University, TX
Colgate University	University of Montana	Tufts University
University of Colorado, Boulder	Mount Holyoke College	Utah State University
Colorado College	Muhlenberg College	University of Utah
Colorado School of Mines	University of New Hampshire	Vassar College
Colorado State University	University of New Mexico	University of Vermont
Columbia College, Chicago	New York University	Washington State University
Cornell College	Northeastern University	Washington University
Cornell University	Northwestern University	University of Washington
Cornish College of the Arts	University of Oklahoma	Weber State University
Curry College	Oregon State University	Wesleyan University
Davidson College	University of Oregon	Westminster College, MO
Denison University	Otterbein University	Westminster College, UT
University of Denver	University of the Pacific	Whitman College
DePaul University	University of Pennsylvania	Whittier College
Dominican University	Pitzer College	Whitworth University
Earlham College	University of Portland	Willamette University
University of Edinburgh, Scotland	Princeton University	Wilson College
Emerson College	University of Puget Sound	College of Wooster
Emily Carr University of Art + Design, Vancouver, BC	University of Redlands	Worcester Polytechnic Institute
	Reed College	



*Philip Layfield, Student Body President*

## GRADUATION AWARDS

Valedictorian  
**Carolyn Austin Wozniak**

Salutatorians  
**Joseph Marken Illingworth**  
**Linnea Joy Zavala**

Aunt Henri Award  
**Philip James Layfield**  
A gift of the school in fond memory of Rowland Hall administrator Henrietta Pearson to a student, chosen by the faculty, who has demonstrated loyalty and dedication to the spirit and ideals of our school.

Bishop's Award  
**Carolyn Austin Wozniak**  
A gift of the Alumni Association in memory of Bishop Daniel Sylvester Tuttle and Bishop Abiel Leonard to the student with the highest academic record in the graduating class.

James Fessenden Award  
**Daniel Flynn Howard Bynum**  
A gift of the family of James Fessenden, Class of 1969, to the senior selected by the student body who is most receptive and responsive to the needs of others.

Chaplain's Award  
**Daniel James Christensen**  
A gift of the Chaplain to the student who best represents the philosophy of Rowland Hall: integration of body, mind, and soul.

Community Service Award  
**Courtney Elizabeth Reed**  
A gift of the school to a senior who has given outstanding community service.

Faculty Award For Service  
**Nathan Zick-Smith**  
A gift of the faculty of Rowland Hall to the student who has given outstanding service to the school.

Student Leadership Award  
**George Marsh Flint IV**  
**Chloe Elizabeth Jones**  
**Courtney Elizabeth Reed**  
A gift of the school to an elected member of Student Council who has demonstrated extraordinary leadership to the council and the school.

English Department Award  
**Chloe Elizabeth Jones**  
A gift of the school for outstanding achievement in English.

History Department Award  
**Philip James Layfield**  
A gift of the school for outstanding achievement in history.

Humanities Award  
**Patrick Hart Crompton**  
A gift of the faculty for outstanding achievement in the humanities.

Science Award  
**Michael Hall-Snyder**  
A gift of the school for outstanding achievement in science.



*Sam Parker, Eileen Veghte, and Daniel Bynum*

**Michael G. Koetter Mathematics Award  
Carolyn Austin Wozniak**

A gift of the school for outstanding achievement in mathematics.

**Latin Award  
Adrienne Rose Murphy**

A gift of the school for outstanding achievement in Latin.

**Françoise Bernhard Scholarship  
Daniel James Christensen  
Beau Patrick Sperry**

In recognition of an accomplished French student whose exuberance and love of the French language are exemplary.

**Spanish Award  
Laurent Christopher Backman**

A gift of the school for outstanding achievement in Spanish.

**Senior Rowmark Award  
James J. Cleason  
Timothy Chase Ryan**

A gift of Rowmark Ski Academy in recognition of outstanding achievement.

**Lee Athlete-Scholar Award  
Joseph Marken Illingworth  
Adrienne Rose Murphy**

A gift of the S. Whitfield Lee family to seniors who have excelled academically and athletically and demonstrated leadership in competitive team sports.

**Outstanding Male Athlete Award  
Nathan Zick-Smith**

A gift of the Athletic Department in recognition of outstanding achievement in sports.

**Outstanding Female Athlete Award  
Ashley Jean Bostrom**

A gift of the Athletic Department in recognition of outstanding achievement in sports.

**Senior Debater Of The Year Award  
Hannah Cheng Zhou**

A gift of the school for outstanding achievement in debate.

American Psychological Association Topss Award

Hannah Rose Midget

Tara Patel

A gift of the American Psychological Association for excellence in the study of psychology.

Tony Larimer Award

Samuel Johnson Prystas Parker

Eileen McGrath Veghte

A gift of the Salt Lake Acting Company, in memory of a beloved teacher, for outstanding achievement in theatre.

Senior Music Award

Daniel Flynn Howard Bynum

A gift of the school for outstanding achievement in music.

George Fox Award

Claire Hoffmann

A gift of the school in remembrance of a beloved teacher, for outstanding achievement in the visual arts.

Senior Dance Award

Chloe Elizabeth Jones

A gift of the school for outstanding achievement in dance.

U.S. Army Reserve National Scholar/Athlete Award

Eric Albee and Nicholas Najeeb Bradley

Sarah Elizabeth Slusher and Wesley Shannon Warner

The Rotary Scholarship Award

**First Place:** Courtney Elizabeth Reed

**Second Place:** Philip James Layfield

**Third Place:** Chloe Elizabeth Jones and Hannah Cheng Zhou

The Salt Lake Exchange Club Award

**Youth of the Month:** Kristie C. Kent and Nathan Zick-Smith

**Youth of the Year:** Kristie C. Kent

National Merit Scholarship Program Award Finalists

Claire Frances Edgley\*

Michael Hall-Snyder

Philip James Layfield

\*Denotes National Merit Scholarship Winner

Longevity Award

Nicholas Najeeb Bradley, Patrick Hart Crompton, Nicholas J. Esparza, George Marsh Flint IV, Colby Hartman, Chloe Elizabeth Jones, Alexander Hayes Kim, Robert Paul Lainhart, Serra Nicole Lakomski, Philip James Layfield, Anna Louise Loughridge, Iris Carlisle Masaryk, Hannah Rose Midget, Abigail Christine Nash, Samuel Johnson Prystas Parker, Tara Patel, Courtney Elizabeth Reed, Zoe Cari Wolcott, Joshua Daniel Wolf, Zachariah Lee Young, Nathan Zick-Smith

Awarded to students who have attended Rowland Hall for at least twelve years.

Prefects

Alexander Hayes Kim, Corin Dean Thummel, Hans Ashforth Wiener, Carolyn Austin Wozniak

## END OF YEAR FACULTY AWARDS

Congratulations to the following teachers who have received awards this spring for outstanding service to their profession and to the school.

The **Sumner Family Faculty Awards** are given each year to outstanding faculty members in each division who have demonstrated a love for teaching and excellence in their fields. It is an award given by a family who has shown an unparalleled commitment to the school for three generations. The award symbolizes the Sumner family's high regard for the faculty. Congratulations to the 2010-2011 recipients of the Sumner Family Faculty Awards:

Beginning School: **Lisa Williams**, 4PreK Assistant Teacher  
Lower School: **Sarah Button**, 5th Grade Teacher  
Middle School: **Sofia Gorder**, Dance Teacher  
Upper School: **Ben Smith**, Upper School Technology,  
Graphic Design and Photography Teacher



*Dr. Carolyn Hickman*

The **Cary Jones Faculty Mentor Award** was established through an anonymous gift to the school in honor of Mr. Jones' dedication to the faculty when he was a trustee and chair of the Board. This year Rowland Hall proudly honors Dr. Carolyn Hickman for demonstrating excellence in the classroom and service to the entire Rowland Hall community with the Cary Jones Faculty Mentor Award.

The **Marquardt Award** was established this year through a generous gift from Bob Marquardt, father of three boys who attended Rowland Hall and a long-time trustee and Board chair. This gift to our endowment will annually fund an extraordinary professional development opportunity to benefit the school as a whole, proposed by a faculty member.

The Marquardt Award for the 2010-2011 school year was awarded to Upper School Physics teacher Robin Hori who proposed, and will receive funding from the Marquardt Award for an innovative project that will introduce Upper School students to the field of robotics. In his proposal he wrote, "Initially, robotics would start off as an after school activity and develop into a trimester course and, possibly, into a year-long, advanced science elective. The curriculum will be from the Robotics Academy developed by Carnegie Mellon University and students will develop a basic understanding of robotics hardware and software through experimentation. They would then build a robot and write a program for the robot to complete a specific task. As the students develop a deeper understanding of robotics and programming, robot design and programming will become more complex." Congratulations and thank you to Robin.

According to Head of School Alan Sparrow, "In its inaugural year, we received five excellent proposals from faculty – all very different, yet valuable – and each worthy of funding. We thank Bob Marquardt for this creative and generous gift to the school that will give back so much to our students."



*Robin Hori*



# ADVANCEMENT

## ANNUAL FUND SURPASSES GOAL

**The Annual Fund closed out the year with a strong finish, successfully raising \$858,010.00.**

This total rose above and beyond the 2010-2011 goal by over \$130,000. The money raised this year went to support a number of essential programs such as continuing education opportunities for faculty, technology upgrades, financial aid, and facility improvements including a much needed overhaul of the Lincoln Street band room to be completed by the end of summer 2011. All of this was made possible by contributions from you – the entire Rowland Hall community of parents, grandparents, faculty, staff, alumni, and friends of the school. Thank you.

**Special thanks go to chairs of the 2010-2011 Annual Fund, Ira Rubinfeld and Willamarie Huelskamp.**

Their tireless dedication and passion for educating everyone about the importance of participation in the Annual Fund were an invaluable part of this year's achievement. Another big thank you goes to the Annual Fund class liaisons who helped raise our parent participation to 75 percent.

### **THANK YOU**

To our amazingly generous faculty and staff who, for seven years, have participated in the Annual Fund at 100%!

## TAKING ON THE ANNUAL FUND, AGAIN!

We are excited to announce that Ira Rubinfeld and Willamarie Huelskamp have agreed to chair the Annual Fund for the 2011-2012 school year. Under their leadership, the 2010-2011 Annual Fund experienced great success, and we are fortunate to have their experience, insight, and dedication for the second year in a row.

This year marks Ira's fifth year of service on the Board of Trustees and during his tenure he has served on the diversity committee, the education committee, the legal committee, and he will continue to serve on the campaign steering committee this coming year. Ira and Willamarie's daughter, Sonia, will be a sophomore this fall.

With one campaign under their belts, Ira and Willamarie were asked to share what they will focus on in the coming year:

### **Participation – *It's About Showing Support for Something You Care About***

We both strongly believe in the importance of participating in the Annual Fund at the ability and comfort level of the individual or family. It isn't just about what you give, it's that you give. Rowland Hall is a unique and special community that supports families in many ways. By participating in the Annual Fund, families show their support for Rowland Hall and all it has to offer.

### **The Bottom Line – *It's Not Just About the Bottom Line***

Some people may not give because they think their contribution, however small, won't mean anything, and that is simply not true. Of course, the Annual Fund is crucial for the school to provide funds for the things that tuition alone doesn't cover, and meeting our fiscal year goal is important. However, any gift – large or small – does more than add to the total dollars raised. The percentage of families who participate at any level shows how much we value Rowland Hall and that we want to help keep it one of the premier independent schools in the country. Outside entities often look to the participation level of the current parent body as a way to determine whether or not to give grants to an institution. It speaks volumes about the culture and nature of a community when a high percentage of members contribute.



*Ira Rubinfeld and Willamarie Huelskamp, Chairs, 2011 - 2012 Annual Fund*

### **Go Green, Give Early**

A great deal of time and effort by so many could be saved if as many people as possible made their contributions early in the year. Paper, printing, postage – all of these materials are used for fundraising in conjunction with volunteer time. Giving to the Annual Fund early in the year supports the fundraising effort as well as saving the time of individuals and the use of resources. It also means you won't be contacted about the Annual Fund for the rest of the year, and you can cross something off your never ending "to do" list.

*So give to the Annual Fund. Give early if you can. Show your support of the school we all believe in and help make the 2011-2012 Annual Fund successful.*

**2010 - 2011 ANNUAL FUND CLASS LIAISON TEAM**

**Special Thanks to:**

Chairs | Ira Rubinfeld and Willamarie Huelskamp

2PK | Scott Shoemate and Tricia Gallagher-Geurtsen

3PK | Paul and Sarah Lehman

4PK | Scott Martin and Rachel Sweet-Martin

Kindergarten | Elizabeth Huelskamp

1st Grade | Lucas and Tristan Smart

2nd Grade | Julie Barbero

3rd Grade | Tom and Heidi Brickey

4th Grade | Joe and Holly Perrin

5th Grade | John and Adrienne McNamara

6th Grade | Bob and Peggy Hunt

7th Grade | Vince Pecora and Karen McCauley

8th Grade | David and Jill Lang

9th Grade | John and Lee Rech

10th Grade | Dann and Deanna Byck

11th Grade | Jordan Kimball and Rebecca England

12th Grade | Clarence and Bill Bynum

**2010 - 2011 FACULTY AND STAFF LIAISONS**

Beginning School | Vicki Smith

Lower School | Jodie Ward

Middle School | Mary Lawlor

Upper School | Doug Wortham

All Staff | Ann Burnett

**2010 - 2011 ANNUAL FUND GIFTS**

Our goal this year was \$725,000.

Gift Range	# of Donors	Range Totals
\$50,000 +	2	\$100,000
\$25,000 +	1	\$25,000
\$10,000 +	18	\$230,423
\$5,000 +	21	\$119,669
\$2,500 +	25	\$99,500
\$1,000 +	138	\$186,536
Under \$1,000 +	744	\$96,882
<b>TOTAL</b>	<b>949</b>	<b>\$858,010</b>

## THE CAMPAIGN FOR ROWLAND HALL : BUILDING THE FUTURE

**Campaign progress** – What a difference seven months makes! From land acquisition to drafting campus plans, from orchestrating a campaign steering committee to initial fundraising – the board is well on its way to determining the scope and timing of a capital campaign to build a new middle and upper school campus.

The new campus will include a regulation-sized soccer field and practice field, two new gymnasiums – one for the Middle School and one for the Upper School, an arts center with space for music, dance, fine arts, theater and studio, a sunlight-filled dining hall, and technologically upgraded classrooms and labs for our students.

Timing and phasing for this effort is now being determined. Our architects, EHDD of San Francisco, have drafted a program outlining exact details for every space of this new campus and our project manager, Ken

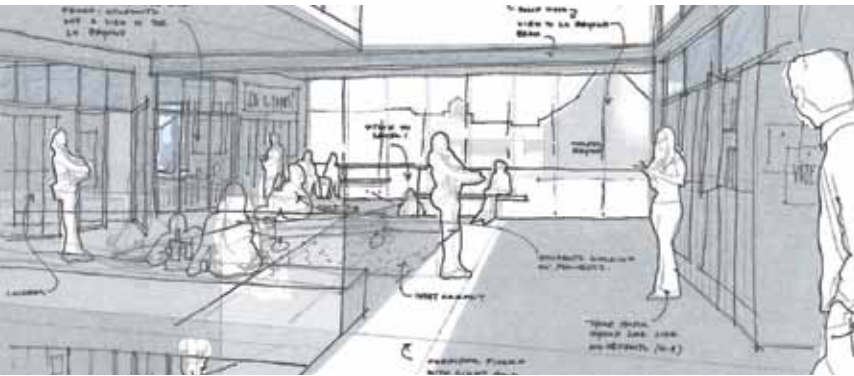

Ament of Salt Lake's Cost Control Corporation, has verified that the new campus will cost \$66 million.

Additionally, and critical to this effort, is the need to raise \$9 million in endowment dollars to ensure the long-term financial stability of the school. Four percent of income from the Endowment Fund supplements the portion of the operating budget that is not funded via tuition, along with proceeds from the Annual Fund.

The grand total for the entire effort of land, building, and endowment is \$75 million. That's a big number. We've heard this number feels insurmountable, hard to "get your arms around," and outright too much, particularly at a time when the economic picture is unsure. Yes, \$75 million is a big number. But consider the following:

**The need is real** – we must build a new campus to offer our students a 21st century education. We cannot upgrade our existing facilities any further – the cost would be far greater. Plus, we physically do not have the space on Lincoln Street to offer needed facilities such as gyms and fields. We need a new campus.

**We're off to a running start.** Impressively, trustees have already raised and personally committed \$14.1 million to the effort. This number includes the recent \$2 million Malone Family Foundation Scholarship Endowment grant as well as \$794k from the sale of a building Rowland Hall owned in Salt Lake's 9th and 9th area.

This school year, we will begin to reach out to friends and families to gain a clearer picture of our fundraising capacity. Parents, grandparents, alumni and friends can expect to hear more detail about the campaign scope and timing soon.

**We can phase the project if need be.** We can break the project into several phases based upon which aspect of the project is of the highest priority for our students and what is cost effective from a construction viewpoint. The Board anticipates making this decision in the coming school year once they have a clearer sense of how much money we can raise this school year.

*If you have specific questions, please contact Director of Development Libby Ellis at 801-924-2984 or [libbyellis@rowlandhall.org](mailto:libbyellis@rowlandhall.org).*

	Needed Funds	Raised to Date
Land and Building	\$66,000,000	\$11,074,504
Endowment	\$9,000,000	\$3,071,486
<b>TOTAL</b>	<b>\$75,000,000</b>	<b>\$14,139,000</b>

**Special Thanks to our Leadership Campaign Supporters**

- Anonymous (1)
- Amy and Barry Baker
- The Ruth Eleanor Bamberger and John Ernest Bamberger Memorial Foundation
- Kurt Larsen and Tyrene Christopulos
- Ben and Lisa Logue
- Bob Marquardt
- The John and Marcia Price Family Foundation
- Ira Rubinfeld and Willamarie Huelskamp
- Bob and Wendy Steiner
- The Steiner Family Foundation
- Paula Swaner-Sargetakis and Joe Sargetakis



**THE MALONE FAMILY FOUNDATION  
GRANTS RH \$2 MILLION FOR SCHOLARSHIPS**

This May Rowland Hall received a prestigious and extraordinarily generous grant to its Endowment Fund – \$2 million – from The Malone Family Foundation. This endowment grant will annually fund financial aid needs for new students in grades seven through 12. The Malone Foundation is a national foundation whose mission it is “to promote positive changes in the lives of people, who in turn can build and enhance the communities in which they live.” Rowland Hall is the only school in Utah and one of only seven schools in the U.S. to receive this grant this year.

Schools do not apply for this grant, but are chosen for eligibility from “a very select” handful of independent schools to receive a Request for Proposal from The Malone Family Foundation. According to the foundation’s Executive Director Cathie Wlaschin, “Rowland Hall was initially chosen as an applicant because of its scholastic record, its college acceptance history, and its accommodations for the gifted and talented, as well as its geographic location in an area not already served by the foundation’s endowments.”

The Malone Family Foundation’s primary goal each year is to provide scholarship funding at a secondary school level for U.S. students who are in the top five percent of their national class and have the desire and drive to educate themselves to the very best of their ability but lack the financial resources to attend excellent independent schools.

We look forward to supporting merit/need-based students as we launch the Malone Scholars program this 2011-2012 school year. If you know of students/families who may fit the criteria for this scholarship, please contact Karen Hyde, Director of Admission at 801-924-5940.



### Welcome Mary Anne Wetzel '01 to New Role as Director of the Annual Fund

With the bittersweet departure of Adria Swindle, we welcome Mary Anne Wetzel as the new director of the Annual Fund. Mary Anne most recently has been working in the Development Department as the development associate –serving the board, acting as the campaign assistant, orchestrating grandparent days, serving as the data manager, and holding all moving parts together. Mary Anne graduated from Rowland Hall as a Cumming Scholar (merit scholarship) and earned her bachelor degree in psychology from the University of Utah. She has worked in the Middle School and admission office as well. Mary Anne brings expertise, dedication, enthusiasm, humor, and great energy to the school and we are thrilled she's stepped into this role.

### Welcome Coral Azarian as the Development Associate

With Mary Anne's promotion, we were fortunate to quickly fill her role with a new and talented young woman, Coral Azarian. Coral is a recent transplant from Easton, Massachusetts, where she attended Stonehill College, earning a BA in American history. Coral has worked in private colleges as an admission counselor and intern. She's a digital native and is eager to explore the "West." Please welcome Coral to the community.

## ENTREPRENEURS CIRCLE UPDATE

Many individuals within the Rowland Hall community, whether they are associated with the school as alumni, current parents, grandparents, or friends, have made their mark in the business world as successful entrepreneurs. To celebrate and share in these individual's knowledge and accomplishments, Rowland Hall has created a new organization of business individuals and companies, the Rowland Hall Entrepreneur's Circle.

The idea was shared with us by one of our parents, Mike Levinthal, who, in volunteer work for Stanford University, participated in a similar effort. The threefold essence of the Entrepreneur's Circle:

**Networking:** The Entrepreneur's Circle provides an avenue for entrepreneurial-minded people to connect with each other to discuss business ventures, brainstorm ideas, and deepen their ties within the entrepreneurial business community.

**Opportunities:** Circle members are committed to providing current students and alumni, as appropriate, opportunities for professional development, internships, idea sharing, and jobs. Lee Thomsen, Upper School principal, will be working with numerous Circle members as the school launches a new program called "Beyond the Classroom," focused on expanding students' understanding of professional job opportunities.

**Giving Back:** Entrepreneurs typically recognize that along the path of their success, a plethora of people played a role and offered help. Circle members believe in giving back to Rowland Hall

– the school and community that offered them so much. In order to join the Circle, individuals/families must pledge a future gift to the school of a minimum of \$50,000. All gifts will support the school's endowment. Their gift is dependent upon the success of their entrepreneurial venture. *Thank you to the following individuals and families who have committed to the Entrepreneur's Circle:*

Anonymous (1)  
Eric and Cynthia Baughman  
Stead and Kendall Burwell  
Ben and Erica Dahl  
Ken Jacquin  
Blake Kirby  
Mike Levinthal  
David and Nancy McNally  
Dave and Tom Stockham  
Tim and Jane Sullivan  
Geoff and Adria Swindle

# COMMUNITY

"I see Rowland Hall as a place where both the mind and heart are valued; a place where students are given the opportunity to grow, make connections, try new things, make mistakes, and excel in a variety of areas. Rowland Hall is a place where students, faculty, parents, and administrators work together with the goal of educating young people."

**Matt Burnett**





## GRANDPARENTS

Over a period of 25 years, we have experienced education at Rowland Hall through the lives of 10 of our grandchildren. We go back to the good-old First Avenue days. The superior education our grandchildren received at Rowland Hall enabled one to become a pediatrician, another a psychologist, another an attorney, and our latest college student graduated in May from UC Berkley in three years rather than four, owing to Advanced Placement credits he earned during his high school years. Our youngest grandchildren, Daphne and Lochlin Michie, will next year be in seventh and fourth grades respectively.

In addition to the excellent academic program, the values stressed at Rowland Hall have enriched our own family dynamics: respect for other students and for diverse backgrounds and personalities, creativity, art appreciation, sportsmanship, community service, modeling of talking through interpersonal problems, concern for others, and personal access to teachers and mentors. When we visit, we know RH is a happy place. Vibrant and original art covers the walls, students are working together in small groups, classrooms are creative and safe places in which to explore, and teachers are fun and approachable.

We are immensely grateful for the whole Rowland Hall experience for our grandchildren – and for what it has meant to their parents as well as to us.

**Nick and Marion Smith,**  
*grandparents of Lochlin and Daphne Smith Michie*

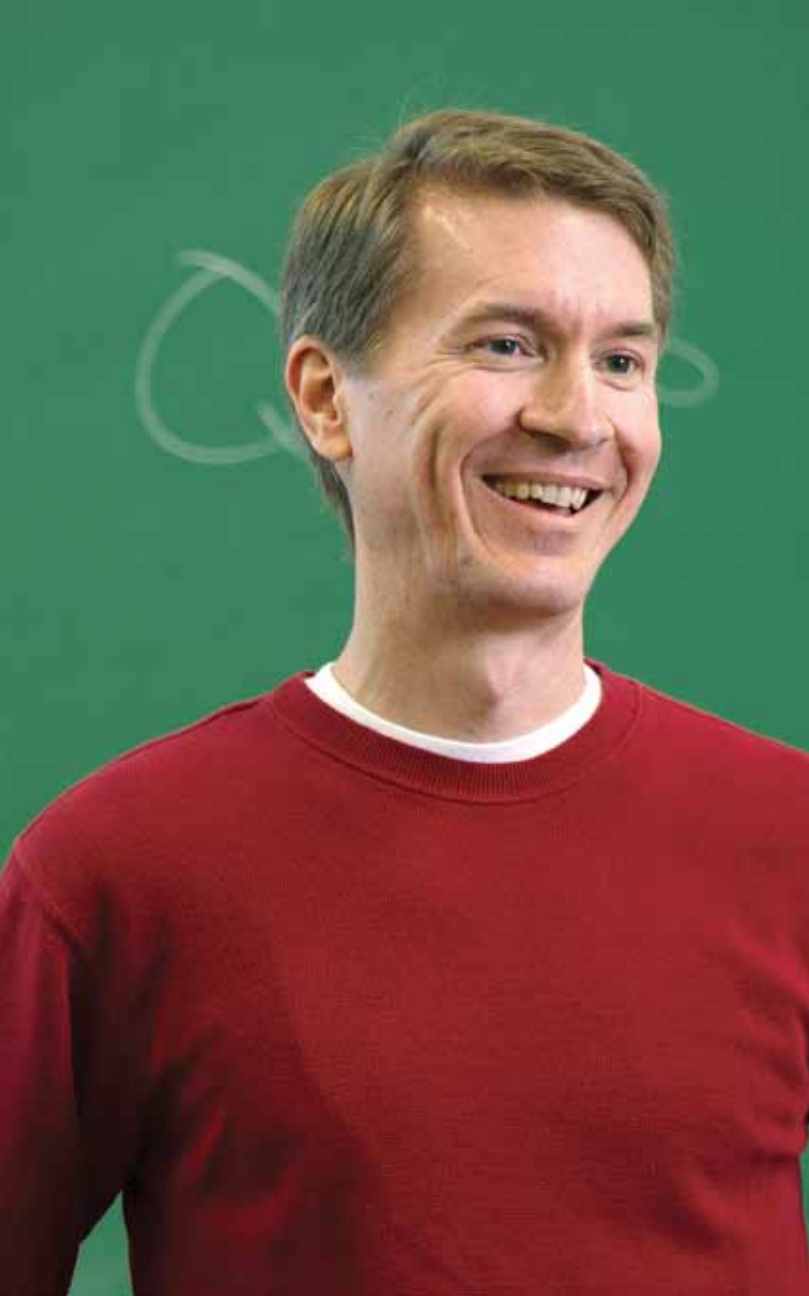

## TEACHER

I have the best job in the world! Okay, this might border on exaggeration, but most days I feel like it's true. One reason is because I get to spend time with some of the most interesting people around – teenagers. They are curious, creative, open to new ideas, unpredictable, up for a challenge (most of the time, anyway), and best of all, they make me laugh.

I am lucky to teach a subject – Spanish – that still excites me. It's fun and rewarding to teach something that is so practical that students can literally walk out of the school and begin to use the skills they learned in the classroom. But along with its practical uses, there are also a number of intangibles that come with learning another language. Students learn about themselves and their own society by looking to other cultures. By communicating in a new language students don't just study another culture, but enter and participate in it.

I am happy to be a part of the Rowland Hall community. As a parent and teacher at our school, I see it as a place where both the mind and heart are valued; a place where students are given the opportunity to grow, make connections, try new things, make mistakes, and excel in a variety of areas. It's a place where students, faculty, parents, and administrators work together with the goal of educating young people.

It's not always easy, but it's my interaction with these groups that keeps me coming back for more each year.

**Matt Burnett,**  
*Upper School Spanish Teacher*



## STUDENT

**“Grab on, I’ll pull you up.”**

One hand clings to the proffered forearm while the other braces itself against the rough sandstone walls beside my knees, held in place only by the force of friction. I haven’t slipped down the side of the canyon because of the bravery of another student, a classmate I haven’t had a real conversation with in years. Nevertheless, here I am trusting him with my safety, and it’s only in retrospect that I find it a little staggering. I manage to pull myself up with his help, and our group continues, negotiating holes we have to swim through and slick boulders thrown here by a volcanic eruption eons ago.

This hike is special, and it’s remarkable that it happened. You see, the eight students on this hike were all seniors, and seniors almost never go on Interim. School’s over, summer’s here, so why go? Just like this hike, why go on an optional day hike that could have been spent lounging around camp? But no, seven friends and I, for by now we were undoubtedly friends, choose to say, “Why not?” Why not go on Interim; the Narrows hike in Zion National Park? So we do, and this one hike showcases what Rowland Hall students can be at their finest: cooperative, brave, resilient, the kind of person you want to hold onto as you dangle over a crevice filled with rock and icy water.

**Hannah Midget ‘11,**  
*matriculating to Whitman College*

## PARENT

My family joined the Rowland Hall family in 2003. Our oldest son, Lawrence, was starting ninth grade and our youngest, Charis, was starting fourth grade. Through sport and various activities I was able to meet other parents and cultivate relationships I cherish today. Our son graduated in 2007 and is now in his senior year at Harvard, yet I continue to keep in touch and socialize with the parents from his Rowland Hall days.

At the beginning of the year, each class has a Parent Social, which is a great way to interact with faculty and other parents of children your children's ages. Rowland Hall's teachers are warm and compassionate, and whenever I visit the school, faculty and staff still ask about Lawrence.

There are so many opportunities to volunteer in the life of the school. For example, Liz Paige directs a service learning program called "Half Day Whole Heart," where the entire high school participates in a half-day of community service throughout Salt Lake City. Parents drive students to various locations to perform services such as working with refugees, singing at the senior citizen's home, and doing yard work and repair for people who are disabled. This is just one example of the countless ways Rowland Hall strives to cultivate the ethics and values in our children that will make them the leaders of tomorrow.

**Carol Benjamin**



## ALUMNUS

When asked to write about how Rowland Hall influenced my life, the first thing that stuck out was the friendships. As I learned from my friends both in undergrad and grad school, it's unique to still have such close ties to high-school friends. In my case, most of my friends are just not high-school friends, but friends I made at Rowland Hall in elementary school. Also, I have the good fortune of having very successful friends in a variety of different professional areas who remain broadly interested in education and learning; I believe this can partially be attributed to Rowland Hall's emphasis on creating well-rounded students. Several of my Rowland Hall friends have even gone on to become teachers. One of the newest teachers on the Salt Lake high school scene is Dave Hausser (class of 2001). Dave is a born teacher, and there is no one my own age from whom I have learned more. One of the things I enjoy most about coming to Salt Lake is meeting up with Dave. Over tea or beer, Dave teaches me about philosophy and history – two subjects I really enjoy but rarely find the time to pursue. I try to talk about some of the new and interesting concepts I have learned in physics and we end up swapping books and more ideas. The talks with Dave are some of the most memorable, transformative, and interesting conversations I've ever had. Similarly, I've learned about non-profits and social entrepreneurship from Preston Nielson, secrets of the culinary world from Ed Heath and Robbie Everest, how to buy a house by the time you are 27 from Mike Elliot, dentistry from David Sandberg, editing, publishing, and startups from Vivek Bidwai, what life is like in Tajikistan from Bo White, everything about Seinfeld from Conor Bentley, criminology from Marc Ruffinogo, and how to “make it rain in real-estate” from Jesse Goldsmith. I feel very lucky for the friends I made at Rowland Hall; I wish them all success in the fascinating careers they are beginning, and I am excited to see what the future holds.

**Ajay Virkar '01**





# ALUMNI

## NEWS FROM THE 1ST MUMS OF ALUMS SOCIAL

On April 29, 2011, Shae Searl (mother of **Tori Searl '06**), Dee Gardner (mother of **Andy Gardner '00** and **Alex Gardner '07**) and Julie Barrett (mother of **Melissa Whalberg '91**, **Elizabeth Barrett '94** and **Emily Barrett '97**) hosted the first “Mums of Alums” event - a social gathering for our mums of alums to get together, reconnect, and update us on what their talented kids are up to. Some updates we heard are below. If you would like to join us at the next Mums of Alums event, call Reagan Tolboe at 801-924-2958.

**Andy Gardner '00** is taking helicopter flying lessons and loving the adventure!

After working for Ernst and Young in Las Vegas, **Gabriel Madlang '98** has moved back to Salt Lake to assume the position of controller and finance manager for TheraDoc.

**Keith Elliott '99** is finishing his residency in anesthesiology. His brother Mike '01 works for Energy Solutions and is soon to be married. Their sister, Elizabeth '07, graduated in May from Brown University.

**David Sandberg '00** is currently a senior dental student at Creighton University.

**Pauline Sargetakis '03** just opened her own boutique in Salt Lake, Precocious K.

**Henry Schwartz '05** is in his second PhD year at Georgia Tech, studying aerospace engineering. He is spending his summer at the NASA Glenn facility in Ohio.

**Mike Sargetakis '06** graduated from the University of Utah this May.

**Sarah Day '06** is living in Bozeman, Montana where she is attending graduate school and is working for an accountant.

**Asher Koles '06** received a degree in environmental studies from the University of Utah in December 2010, and is employed as a research associate with Salt Lake-based Round River Conservation.

**Alexandra Jacobs '07** graduated from USC on May 13, 2011. She will be engaged with Teach for America in Nashville, Tennessee.

**Alex Gardner '07** graduated from University of Puget Sound in May 2011 and is working for Beta Theta Pi National Fraternity in the Philadelphia, Maryland, Virginia, and North Carolina regions.

**Caitlin Jacobs '09** is attending USC, and working part-time in the admission office. She plans to study abroad in Australia or New Zealand in Spring 2012.

## CLASS UPDATES

**Candy Kolb '69** recently launched a new business in Salt Lake. Expedite LLC offers errand and personal concierge services for busy professionals. While clients are busy working, biking, traveling, or going to a child's soccer game, Expedite can be doing the grocery shopping, walking the dog, taking the car for service, waiting for the cable guy, and picking up the dry cleaning; whatever mundane chores make life feel more frantic than it needs to be. And tomorrow, she can drop off the perfect birthday gift that you almost forgot for your mother-in-law, beautifully wrapped with a card ready for you to sign. To reach Expedite (or Candy), call 801-440-5380 or email [candace@expeditellc.co](mailto:candace@expeditellc.co).

**Jonathan Hodge '90** and family – wife Karyn, daughter Lily, eight, and son Charlie, four – are in full summer swing here in Salt Lake. In between travel for work, swim team with Kelly and Jennifer Bone Hannah's girls, and camp after relentless camp, the clan is squeezing in some time at their favorite spot in Island Park, Idaho. September 2011 marks an exciting time for the Hodges, as they will be hosting a Rowland Hall student from Sweden while he spends his senior year here in the U.S.

**Dave Collins '90** runs a nonprofit called Tierralegre that is creating an eco-center in Mexico, to help boost ecological literacy in the local community and providing courses to national and international students through Tierralegre Institute. One of the courses is "Building with Bamboo," in which students learn to cultivate and build with bamboo – including the center's building! Their new website under construction is live at [www.conservationmexico.org](http://www.conservationmexico.org). For fun, Dave spends a lot of time stand-up paddle surfing.

**Romney Williams '90** moved with his family to Broomfield, Colorado (between Denver and Boulder), last August. He is currently president of an enterprise software start-up called Accurrence, which develops on-site claims inspection tools for property insurance carriers. Romney's children are ages 12, 10, seven, and five years old.

**Sayuri Itabashi '90** wrote in to express her appreciation, representing the people of Japan, for the thoughts and support from the U.S., and the many other nations as well, following the devastating earthquake and tsunami. Sayuri said, "It may take years to recover but we will!" She added that all is well in Yokohama, except the electricity issues.

**Heather VanDeventer '90** is returning to parish ministry, she will be associate rector at Christ Church Episcopal in Old Town Alexandria, Virginia, where you can visit and sit in George Washington's pew! Heather said she loved reading the extended article on the debate team in the last REVIEW – she still has her late 80's vintage Verbal Assault Team sweatshirt!

**Hillary Rogers '92** is engaged to Rick Revell. The couple plans to marry in early 2012. Hillary and Rick live in New York City where they are both freelance producers.

**Macey Mott '94** lives in Jackson, Wyoming. She marks her 10-year anniversary with Aspen Travel this July. She also runs a non-profit theatre company, Riot Act, Inc., and teaches Swing Dance. She sits as a board member of the Cultural Council of Jackson Hole and is an artist on the roster of the Wyoming Arts Council. Macey is also an animal lover with two adorable cats.



**Christopher Von Maack '97** was recently named partner at the law firm of Magleby & Greenwood, P.C. in Salt Lake.



*Jaeger and  
Tony with  
baby Henry*

**Jaeger Agraz Ashton '99** and her husband, **Tony Ashton '97**, welcomed their first child, Henry, on March 2, 2011. They currently live in Boston, Massachusetts, where she is a pediatric nurse practitioner at Whittier Street Health Center.

**Brooke Warburton Flavin '98** is pregnant and the baby is due this fall.

**Tania '02** and **Jeff Miller '98** had their first child, Natalie Margaret Miller on April 27, 2011. Jeff and Tania manage Mark Miller Subaru South Towne together. Jeff is the general manager and Tania is the controller.



*Tania and Jeff with  
baby Natalie*

**Andrea Williams '99** is living in Denver and is recently engaged. She also received her certificate as a certified school social worker.

**Patrick Sullivan '99** is a medical residency graduate from Philadelphia Children's Hospital.

**Amanda Miller '99** is living in Houston where she is finishing clinical hours to become a dietician.

**Maggie Behle '99** is living in Austin, Texas, working on becoming a high school English teacher. She and her partner, Lisa Braun, just bought their first house and live with their two rescue dogs, Judah and Penny.

**Lynzy Burke '99** is still living in Seward, Alaska, helping run Adventure Sixty North, a kayak and outdoor adventure company, which she co-founded in 2007. She and her boyfriend, Evan, plan to move to Newport, Oregon, in the next couple of years where she will begin nursing school.

Congrats to **Robert Saunders '99** who recently passed bar exams. He moved back to Utah and has opened a Park City based law firm, Saunders Law, PLLC. He is excited to be back in Utah and looks forward to reconnecting with local alums!

**James Allred '99** recently graduated from University of Utah Medical School. He will intern in Salt Lake with Intermountain Medical Center and will then move to Austin, Texas, with his family (wife is **Suzannah Pels Allred '98**) to study dermatology for the next three years.

**David Hausser '01** recently finished his student teaching at Highland High and will receive his teaching certificate in history.

**John Drake '01** received his JD from Gonzaga University.

## IN MEMORIAM

**Roslyn Dupler Fitch '74** passed away April 9, 2011. Our sympathies go to her family and friends.

**Joan Lingenfelter Warnock** died on May 23, 2011. Our prayers go out to her family and loved ones.



**Sarah Evershed '02** owns her own company called The Cloud Media. It is a boutique management firm specializing in business development and branded content for online video content creators. They work with some of the biggest YouTube stars in the world as well as some of the biggest brands including Pepsi, GE, Disney, Microsoft, and Virgin Mobile.

**Marcus Anderson '02** currently resides in Philadelphia where he attends UPenn and is working on a two-year full-time dual degree, MBA + MA in international studies, focus in the Portuguese language, at the Wharton School of Business.

**Maribeth LeHoux '02** graduated this June from The University of Chicago Law School. She will be moving to NYC to start as a corporate associate at Debevoise & Plimpton and hopes to see some Winged Lions in the city!

**Adrienne Martain Black '02** is living on Capitol Hill and just celebrated her third wedding anniversary. She is still working at US Bank as a relationship manager in commercial real estate finance and teaching yoga across the street from Rowland Hall at Centered City Yoga. Her husband is pursuing a graduate degree in geological engineering.

**Vanessa Clayton '02** graduated this May from The S.J. Quinney College of Law, at the University of Utah. She spent the summer in Connecticut working at a human rights NGO and will begin work at the University of Utah's Office of General Counsel this fall.

**Kristen Lence '04** is in the process of starting a non-profit after-school program in Los Angeles with several of her friends from college. Their program, called The Bridge on Melrose, will provide daily after-school tutoring, free of charge, for students in the Hollywood area. They will specifically focus on helping students build the knowledge and confidence required to succeed in math and science. Although they target at-risk schools and neighborhoods there is no particular income requirement for participants. They are about to begin renovations on their facility and hope to be up and running this fall. Kristen received her bachelor's and master's from Stanford University in earth systems in 2008 and 2009, respectively.

**Natalie Singer '04** graduated in May from the Monterey Institute of International Studies, a graduate school of Middlebury College in Monterey, California, with a masters degree in international policy studies and conflict resolution.

**Michael Kroesche '04** received his MFA in English from UNLV in May. He has successfully defended his thesis, a collection of poems entitled "Raise the Still Rabbit" and is looking forward to graduation. This is an international program and each MFA candidate is required to spend ten weeks in another country, immersed in the culture and language of that country. Michael spent last summer in Quebec writing and completing a phonetic translation of the poetry of Stéphane Mallarmé. His final critical paper was on the poet Paul Blackburn. Most recently, his poem "Aviary" and an essay he has written on Eco Poetry have been accepted to be published in *Interim*, a literary journal.

**Jenn Livermore '10** is living in San Francisco this summer where she has an internship with The Nature Conservancy. She has been hanging out with Maddie Loughridge '09, who also has an internship in the city with the producers of the film *Miss Representation*. Learn more about the film at [www.missrepresentation.org](http://www.missrepresentation.org).

**Jacob Hampton '04** is currently serving a one-year pharmacy residency in Billings, Montana. He enjoyed a month-long pharmacy rotation in Thailand in Feb/March of 2011. While in Thailand he toured many different medical facilities and an orphanage, and took an elephant ride through the jungle. As much as he enjoyed these various experiences, he chose not to partake of the deep-fried scorpions! Jacob received his Pharm.D. from the University of Utah School of Pharmacy in May 2011. He celebrated his graduation with brother **Zach Hampton '00**, who is currently working as Data Services Specialist for Advance MD/ADP. Zach has enjoyed trips to France and Ireland the past couple of years. He is currently residing in Murray, Utah with his girlfriend and two lively dogs.



*Jacob and Zach Hampton*

## ALUMNI SPOTLIGHT



Beehive Sport and Social Club is a brand new alumni business in Salt Lake dedicated to organizing co-ed, social sports leagues. Beehive Sport and Social Club is the brainchild of two alums, **David Marquardt '04** and **James Accettura '04**. Designed to deliver “intramural fun built for adults,” they founded BeehiveSSC to provide Salt Lake’s young professional community the opportunity to recreate and socialize in a casual setting. Absent along the Wasatch Front until now, social sports clubs have taken hold in nearly all other major US cities. Partnering with local bars and restaurants to provide postgame food and drink discounts, BeehiveSSC began its

inaugural kickball season July 7th.

After kickball they will continue the fun with flag football and then dodgeball after the new year. According to the guys, “We plan to add sports as our members’ demand dictates but we’re currently eyeing a wiffleball season in 2012. Every season we have committed to donate \$3 of every member’s registration fee to the Boys and Girls Club of Greater Salt Lake - our way of giving back to the community.” For more information on Beehive Sport and Social Club and to register for Fall Flag Football please visit [www.BeehiveSports.com](http://www.BeehiveSports.com).



# DONORS

Roary, our handsome new Winged Lion mascot, thanks you for your support!

## DONOR THANKS

### Annual Fund Donors 2010 - 2011

Rowland Hall wishes to thank all of the following donors who generously contributed to the school's 2010-2011 Annual Fund.

#### HEADMASTER'S COUNCIL (\$10,000 +)

Anonymous (3)  
Amy and Barry Baker  
John Bird and Rin Harris  
Glenda and Jim Bradley  
David and Romy Cohen  
Compax  
Goldman Sachs  
Phil and Gloria Horsley  
Kanter Family Foundation  
Jordan Kimball and Rebecca England  
Jerry Lanchbury and Margaret Hall  
Kurt Larsen and Tyrene Christopoulos  
Terri McCarthy  
Vivian and Kim McGuire  
Jennifer Price-Wallin and Tony Wallin  
R. Harold Burton Foundation  
Rio Tinto Shared Services  
Steiner Foundation, Inc.  
Bob and Wendy Steiner  
Tim and Jane Sullivan

#### HALLMARKER GOLD (\$5,000-\$9,999)

Beth and Michael Chardack  
Cumming Foundation  
David E. Cumming Foundation  
John D. Cumming Family Foundation  
Francis and Robin Dunleavy  
Chip and Gayle Everest  
The Jacquelyn & Gregory Zehner Foundation  
Siew Hong Lam and Lee Min Lau  
Jill and David Lang  
Steve and Michelle Lessnick  
The M Lazy M Foundation  
The Mark and Kathie Miller Foundation  
John and Adrienne McNamara  
Owen and Jean Moran  
Rhonda and Bill Nicoloff  
Ira Rubinfeld and Willamarie Huelskamp

Mitch and Teresa Silverman  
Paula Swaner-Sargetakis and Joe Sargetakis  
Target Bank  
Wells Fargo Foundation Educational Matching  
Gift Program

#### HALLMARKER SILVER (\$2,500-\$4,999)

David and Rocio Andrews  
Richard Badenhausen and Katherine Venti  
Brian and Karey Barker  
Gerald and Janet Carlisle  
The David J. and Nancy L. McNally Foundation  
Spencer and Ann Galt  
Tiffany and Rob Glasgow  
Linda and Charlie Graves  
Gerald and Julia Johansson  
Jeff and Sharon Jonas  
Benjamin Kim  
Mark Klose and Andrea Smith  
Ben and Lisa Logue  
Akemi and David Louchheim  
Jim Macintyre and Liz Joy  
Tami and Jane Marquardt  
Phil and Sandy McCarthy  
Jim Michie and Wendy Smith  
Owen and Jean Moran  
Steve and Courtenay Porges  
RJ Foundation  
Sawtooth Capital Partners, LLC  
Eric Scaife and Caroline Milne  
Saba Siddiqui and Faizi Siddiqi  
Gordon and Emily Smith  
Zach and Janelle Smith  
Carolyn Sterrett  
Leslie and Hal Stone  
Paul and Charlyne Wozniak

#### HALLMARKER BRONZE (\$1,000-\$2,499)

Anonymous (1)  
Michael and Bobby Abrams  
Steve Achelis  
Jack and Darcy Amiel  
Jon and Heather Armstrong  
Roger and Susan Arsh  
Michael Axelrod and Julia Simovsky  
Richard and Margot Badenhausen  
John Ballard and Karen Miller

Mike and Susan Balogh  
Kevin and Linette Baneth  
Jim and Holly Barringham  
Julie and Bill Barrett  
Bill Barron  
Pat Bearson  
Joe and Gainor Bennett  
Tom and Heidi Brickey  
Denis and Kathryn Brown  
Branden and April Burningham  
Stead and Kendall Burwell  
William and Mollie Campbell  
Dianna Cannon and Marva Match  
Caridad Corporation  
Jim Carlisle and Kristine Kokeny  
James Jong-Ming Chang and Jennifer Pei-Chen Kao  
Hiram and Priya Chodosh  
Erik and Michele Christiansen  
Chris and Cindy Cutler  
Ben and Erica Dahl  
Wes Davis and Leigh Travis  
Evan Deneris and Susan Opp  
Peter and Joan Diamandis  
Mike and Sue Diehl  
Jim and Gerylyn Dreyfous  
James and Kris Dumas  
Roger and Karen Edgley  
Ira and Lili Field  
Steven and Nicky Firth  
Kelly and Ethan Fisher  
Kirk and Tanya Fleischer  
Jeff and Katie Fort  
Franklin Templeton Investments  
Floss and Sandy Frucher  
Colin and Dee Gardner  
Bill and Barbara Gibbons  
Sam Goldstein  
Google Matching Gifts Program  
Joseph and Catherine Graham  
Amy Herbener  
Fred and KK Heslop  
David and Christine Hochhauser  
Leo and Harriet Hopf  
Darren and Lisa Housel  
Bob and Peggy Hunt  
Gavin and Jennifer Hunter  
James Hyde and Angelina Beitia  
Tom Illingworth and Mary Darling-Illingworth  
George and Nancy Janes

*This Annual Report lists gifts made from July 1, 2010 through June 30, 2011. In spite of our careful attempts to be accurate, mistakes do occur. If you have made a gift to Rowland Hall during the fiscal year and your name has been omitted, misspelled, or listed incorrectly, please accept our sincere apologies and advise us of the error by calling Mary Anne Wetzel in the Development Office at 801.924.2961. Out of respect and for purposes of consistency, all grandparents' names are listed formally.*

Ken and Noriene Jee  
 John L. & Ardis J. Piers Private Foundation  
 Cary Jones and Kristin Hopfenbeck  
 Karl and Beata Kieffer  
 Blake Kirby  
 Mike and Diane Koetter  
 Bobby Kwun and Patty Yun  
 Kay Lamb  
 Garit Lawson and Erin Bolton  
 Paul and Sarah Lehman  
 Rob and Ann-Marie Lence  
 Gary Lindemann  
 Alfred and Jocelyn Lutter  
 Macy's Foundation  
 Bob Marquardt  
 Scott and Connie Maves  
 Kim McFarland  
 Margaret Niver McGann and Chris McGann  
 Microsoft Giving Campaign  
 Mark and Gina Miller  
 Harold Miller  
 Steve and Julia Moore  
 Steve and Mikelle Moore  
 Andrew and Leigh Ann Morse  
 Aaron Murphy and Jennifer Gully  
 Harlan and Faye Muntz  
 Clyde Nelson

Joe and Sylvia Nielsen  
 Paul and Christiane Nkoy  
 Northrop Grumman Foundation  
 Mark and Karen Oliver  
 Allison and Mark Paradise  
 Jaeyoon and Whaja Kim Park  
 Don and Holly Pruett  
 Robin and Raj Puri  
 The Reagan Foundation  
 David and Laura Rinn  
 James and Christine Riter  
 Christopher and Kari-Anne Roach  
 Michael and Robin Rollins  
 Brian and Janice Ruggles  
 Jack and Judy Schiefer  
 Peter and Margie Schloesser  
 Brian and Christine Seethaler  
 Pawan and Anita Sharma  
 William and Nancy Shott  
 Allan and Thalia Smart  
 Luke and Tristan Smart  
 Dale Smith and Wendy Matis  
 TG and Doris Solomon  
 Kaveh and Jacquelyn Someah  
 Alan and Nancy Sparrow  
 Bruce Sperry  
 Mark and Peggy Squiers

Jim Steele and Linda Wolcott  
 Paul Stotts  
 Greg and Theresa Sueoka  
 Robert Summerfield and Isabel Moreira  
 Rachel Sweet Martin and Scott Martin  
 Jack and Michelle Szwajkun  
 Guy Thomas and Halle Lamble  
 Robert and Bec Thompson  
 Tom Thorne and Holly Clark  
 Mike Tonneson  
 Reed and Anna Topham  
 Bob and Lynette Tucker  
 Katie Turnbull  
 Sarah Uram  
 Willem and Janelle Van Der Werf  
 Michael Varner and Kathleen Digre  
 Shari and C.J. Veverka  
 Dave and Peggy Wade  
 Peter and Karen Weiss  
 Bill and Alane White  
 John and Elizabeth Whittle  
 Brian Wilkinson and Mimi Charles  
 Hongsuk Yang and Soohyun Park

Bill Barron  
 Bennett and Kelly Bartley  
 Don Basile and Kirsten Novak  
 Ryan and Joy Bateman  
 Bob Bauer  
 Bill and Sarah Baxter  
 Tim Beals  
 Andrea Beckman  
 Ivor and Carol Benjamin  
 Stephen and Aymi Bennhoff  
 Jason Bergreen and Abby Bacon  
 Paul and Ann Bernstein  
 Amy Bird  
 Roberta Bocock  
 Marc Bodson  
 Jay and Dena Boniface  
 Doug and Donna Booher  
 Phil Bossart and Sharon Strong  
 Todd and Monika Brickson  
 Trace and Karen Browning  
 Lawrence and Isabelle Buhler  
 Zenon and Katrina Bulka  
 Steve and Cindy Burian  
 Dan and Megan Burick  
 Matt and Valerie Burnett  
 Ken and Ann Burnett

#### CONTRIBUTORS 2010-2011

Anonymous (40)  
 Abbott Laboratories Fund  
 Bjorn Ablad  
 Michael and Elaine Ackerman  
 Wayne and Kathy Adams  
 American Express Foundation  
 Pat Ammon  
 Tara Anderson  
 Brad Anderson and Maija Holsti  
 David and Alison Anderson  
 Carly Anderson  
 Carl and Leila Armknecht  
 Roger and Mary Armstrong  
 Anthony Arnason and Sally Wakefield  
 Crystal Ashton  
 Roger and Lisa Atkin  
 Simon and Michelle Atkinson  
 Rie Attridge  
 Holly Ausbeck  
 Amber Ayers  
 Feras Bader and Susan Abu-Khalaf  
 Mark Baer and Chris Sparrer Baer  
 Leta Baker  
 Nate and Jacee Ballard  
 Brent and Anne Baranko  
 Edward and Melissa Barbanell  
 Kyle and Melissa Barnett

Nick Burns  
 Tyler and Jane Bushnell  
 Cliff Butter and Marilyn Osborne  
 Mark and Sarah Button  
 Pati Callahan  
 M.C. and Karen Campbell  
 Martin Caravati and Wanda Updike  
 Tom and Ashley Carlin  
 Dane and Emily Carlson  
 David and Kerry Carlson  
 Lauren Carpenter  
 Keith and Yuri Chan  
 Dale and Margaret Chapman  
 Chevron Matching Gift Program  
 Pat Christensen  
 Raymond and Jamee Christensen  
 Kelly Cockrell  
 Bill and Carol Collard  
 Ross and Susan Collier  
 Patti Collins  
 Bruce and Julie Cooper  
 Thomas and Mary Jane Cork  
 Keith Cormier and Cassandra Van Buren  
 Corporation of the Episcopal Church in Utah  
 Scott and Karen Cottingham  
 William and Marie Couldwell



*Mary Anne Wetzel, Whaja Kim, Mascot Rouxy, and Jaeyoon Park*

Scott and Kristin Cowdrey  
Toby Cox and Liz O'Brien  
Randy and Debbie Crail  
Laura Czajkowski and Gail Murdock  
Kib and Sara Dacklin  
Jennifer Dailey  
Bill and Judy Dalgliesh  
Dru and Amy Damico  
John and Alesa Davis  
Bill and Jeanne Davison  
Julie DeBlanc  
Michael Deibele and Lee Ellington  
Chris and Amy DeLap  
Ric and Janice DelMar  
Tricia DeMoux  
Julie Denkers-Bishop  
Edward and Deanna DiBella  
Ron and Diana Dichter  
Steve and Sandra Diehl  
Andrew and Marianne Dischmann  
Ben and Alexandra Doctorman  
Gary and Karen Doctorman  
Jack and Joyce Dolcourt  
Robert Donohoe  
Grant and Ellen Donovan  
Curt and Susan Dowd  
Alexa DuBois  
Dan Duggleby and Amy Geroso  
Nathan and Amy Durham  
Robert Dustman  
Nile Eatmon and Kim Hornak  
eBay Foundation Gift Matching Program  
Thomas Eckfeldt and Kim Stephens  
Brian and Jean Elkington  
Jim Eng and Faye Mitsunaga  
Dan and Anna Ernst  
Theresa Espinosa  
Gary and Paula Evershed  
Beverly Facklam  
Charles and Annet Falls  
Sean and Mandy Fanning  
Rita Swenson  
Jason and Dawn Farrell  
Imad and Hanadi Farrukh  
Barry and Cindy Feinman  
Wes Felix and Karmen Schmid  
Steve and Wendy Fenton  
Peter and Bonnie Feola  
Hugh and Kate Ferguson  
David and Cathy Fischer  
Mark and Lara Fisher  
Erich and Celeste Flynn  
John Foley and Dorene Sambado

Dennis and Lori Forchic  
Nickolaus and Felicity Fouche  
Joe and Shannon Fox  
George Fox  
Efanga and Ini Frank  
Stan Freck and Tina Braun  
Bob Frey and Sally Ormsby  
Friends of Rowland Hall  
David and Carol Frymire  
Dave and Jackie Fuhrman  
Brian Fukushima and Tammy Park  
Stacy Gaggero  
Mickey and Sharee Gallivan  
Brian and Sarah Getzelman  
Eric and Liza Gilbert  
Greg Glazier  
Patrick and Mardee Godfrey  
Steve Goldman and Kris McHugh Goldman  
Sofia Gorder  
Bert Granberg and Felicia Olivera  
Michael and Jennifer Granger  
Kipp Greene and Jeanne Zeigler  
Missy Greis  
Patrick Greis  
John Griffiths and Mary Ciminelli  
David Grunwald and Ellen Wilson  
Chip and Jacquie Guarente  
Gema Guevara and John Reed  
Diane Guido  
Finn and Kathy Gundersen  
John and Jessica Guynn  
Cory and Kimberly Hacking  
Dave and Becky Hall  
Tamra Hall  
Vernon Hall  
Charles and Fiona Halloran  
Linda Hampton  
Peter Hanlon  
Dugg and Ann Marie Hannon  
Chris and Megan Hanrahan  
Scott Hansen and Peggy Norton  
Kevin and Amy Hanson  
Bobby Hanson  
Dave and Julie Harper  
Sheri Harris  
Ron Harris and Melissa Eckman  
Sibyl Hart  
Stephen and Wesley Hartsell  
James Harvey and Christine Greenwood  
Pete and Jen Hathaway  
Chris and Tasha Hatton  
Robert Hauck and Libby Sunderman  
Robert Hausser

Peter and Thi-Ly Hayes  
Rachel Hayes  
Kirsten Hepburn  
Dorothy Herrington  
Josh and Carolyn Hickman  
Chris Hill and Jacqui Wittmeyer  
Graham and Eliza Hill  
Mary Hill  
Aaron and Lindsay Hinton  
Troy and Ashley Holbrook  
Phillip and Naomi Holm  
Robin and Cynthia Hori  
Stanley Holmes and Rebecca Horn  
Kathy Howa and Kendra Tomsic  
Perry Hull and Liz Paige  
Gavin and Jennifer Hunter  
Bruce Hunter  
Karen Hyde  
Robert Immitt  
Bret and Nicole Jackson  
Thaddeus Jacobs  
Ken and Mary Jacquin  
Bill and Jane Janke  
Wally and Karen Jarman  
Peter and Katrina Jensen  
Leslie Jensen  
Jerry Jensen and Ellen Hastings  
Jewish Community Foundation of Colorado  
Shawn and Heather Johnson  
Laura Johnson  
Wes and Lila Johnson  
Ronald and Holly Jorgensen  
Eric and Kathleen Juhlin  
Geoff and Kami Kahler  
Doug and Erica Keil  
Bobby and Kathy Kennedy  
Dave Kerwynn  
Davar Khoshnevisan and Irina Gushin  
Kick Like A Girl, LLC  
Martyn and Louise Kingston  
Carl and Gilleen Kjeldsberg  
Regina Klein  
David and Stephanie Klein  
Chris Kline  
Dieter Knecht  
Mike Kobayashi and Shoko Suzuki  
Joseph Kolb and Elissa Stern-Kolb  
Susan Koles  
Rodney Kopish  
Jeffrey and Jaime Kovnick  
Guy and Carol Kroesche  
L3 Communications

Daniel and Nancy Labov  
Jack and Betty Lampros  
Scott and Aimee Langone  
Peter Larcom and Maryellyn Gilfeather  
Brent Larsen  
Mary Lawlor and Dawn Houghton  
Linda Leaver  
Richard Lemons and Diana Banks  
Carolyn Leone  
Felix Leung and Dolly Peach  
Patty Lewis  
Bernard and Lauren Liang  
Ben and Katie Lieberman  
Yuan Lin and Hongwei Xu  
Peter and Jessica Lindgren  
Dave and Carol Littlefield  
Avery and Erin Littlefield  
Dave and Rebecca Livermore  
Larry Livsey  
William Lockhart and Terri Martin  
Jeffrey and Alison Lockman  
Joel Long  
John Lopez  
Will and Carter Lowrance  
Tom Lyness and Laurie Hilyer  
John MacFarlane  
Mike and Kim Mack  
Shawn and Ivette MacQueen  
Charles Mallender and Angela Anderson  
Joleen Mantas  
Joel and Mary Jo Marker  
Shelley Marshall  
Timothy and Claire Martin  
Stephanie Martin  
Robyn Matheson  
Kyle and Evelyn Matsumura  
Rob Mayer and Carol Blackwell  
Kevin and Robin Mayetani  
Andrew and Barbra McCabe  
Stuart and Peggy McCandless  
Tim and Erika McCarthy  
Bud McManus  
Michael Measom and Rebecca Lucille  
Rob and Susanna Mellor  
Heidi Memmott  
Tom and Nancy Merrill  
Hamid and Tehmina Mian  
Travis Mickelson and Margot Miller  
Derek and Phyllis Mikuriya  
Dennis and Jo Ellen Millard  
Brian and Lori Miller  
Tracy Mills and Elizabeth Hruby-Mills  
Rick and Lisa Miranda

Dan and Joy Mitchell  
 Mike and Deborah Mohrman  
 Steven Mond and Jennifer Elsen  
 Gene and Geri Mondragon  
 Julie Roberts-Morris  
 Winny Mugweh  
 Derek and Melissa Muhlestein  
 David and Fran Munday  
 Daniel Naatz  
 David Naatz and Ginah Mortensen  
 Ken and Janet Nelson  
 Teresa Nelson  
 Allen and Kate Nevins  
 Jeff and Marsha Newman  
 Tran Nguyen and Tuyet Phan  
 Scott and Kathleen Nichols  
 John Nichols  
 Kelly and April Nielsen  
 Gary and Heather Nielson  
 Chard and Kristina Obermark  
 Cathi O'Brien  
 Alan Okawa and Allison Oki  
 Jason and Jazmin Olsen  
 Serge and Maura Olszanskij  
 Trey and Laura O'Neal  
 Mike and Stephanie Orfanakis  
 James and Melissa Orford  
 Brandon and Beth Ott  
 Joe and D.A. Palmer  
 Harry and Maria Pappasideris  
 Larry Parker and Wanda Pillow  
 Kody Partridge  
 Kelly and Jeane Patterson  
 Kip and Terri Paul  
 Vince Pecora and Karen McCauley  
 PJ Pedersen and Mary Ellen Domeier  
 Joe and Holly Perrin  
 Erich and Nancy Petersen  
 Peter and Anne Peterson  
 Richard and Lois Peterson  
 Lynne Peterson and Greg Parks  
 Pfizer Foundation Matching Gift Program  
 John and Alice Poinier  
 Jeff and Susie Polychronis  
 Richard and Jill Pope  
 Troy Price  
 Pierre and Laura Prosper  
 Tiffanie Provost  
 Mark and Jennifer Purcell  
 Patrick and Elizabeth Purcell  
 Scott and Vera Putman  
 Kasim and Zehrija Rahislic

Kira Rama  
 Andre Ramjouw  
 Chris and Jenny Ramos  
 James and Terri Ramsey  
 Marc and Michelle Rasich  
 Randy Rasmussen and Heather Ross  
 Raytheon Matching Gifts for Education Program  
 John and Lee Rech  
 Thomas and Leslie Reese  
 Tim and Nia Reganis  
 Angelo and Stella Restrepo  
 Bart and Georgia Reuling  
 Betsy Revenaugh  
 Christopher and Anne Rich  
 David and Faith Ritter  
 Robert Wood Johnson Foundation  
 Mike Roberts  
 Mae Roberts  
 Sallee Robinson and Leslie Sutter  
 Luz Robles  
 Robert and Dawn Rodgers  
 Kent Rodriguez  
 Don Rogers and Diane Nicholson  
 Trel Rohovit and Jenny Wilson  
 Robert and Diane Rolfs  
 Margaret Rose  
 Debbie Rounds  
 Michelle Royer  
 Stuart Ruckman and Libby Ellis  
 Gina Russo  
 Thomas Rust and Gloria Gonzales  
 Salt Lake Acting Company  
 David and Heidi Samuels  
 Wally Sandack  
 Osman Sanyer  
 John Sarbo and Kathryn Czarnecki  
 Nicholas and Heather Satovick  
 Dave and Shelley Saxton  
 Alex and Carolyn Schabel  
 Wolfgang and Waltraude Schlemmer  
 Gary and Alisha Schlichter  
 Jim and Jan Schott  
 Rob Schreck and Cindy Prass  
 Katie Schwab  
 John Schwiebert and Ann Jefferds  
 Select Equity Group Foundation  
 Akram Shaaban and Inji Elkasaby  
 Mike and Carol Shackelford  
 Shaun Shakib and Sabine Koepf-Shakib  
 Bill Shann  
 Emily Shaw  
 Jason and Jamie Shaw



*Shari Veverka*

Dennis and Mary Sheehan  
 David and Tiffany Shewell  
 Fuad and Samar Shihab  
 Julie Shipman  
 Jim Shipman  
 Kurt and LaVonne Shirkey  
 Joe and Necia Shumway  
 Dave and Stacia Sidlow  
 Hilary Silberman  
 Jonathan and Ruth Silverstein  
 Christa Sinclair  
 Dallas and Tara Sinquefield  
 Debra Sjoblom  
 Lynn and Debbie Skidmore  
 Sam Sleiman  
 Hubbert and Vicki Smith  
 Blair and Anne Smith  
 Cameron Smith and Piper Rhodes  
 Tim and Becky Snyder  
 Rhonda Sparrow  
 Kenneth and Claudia Sperling  
 Cynthia Spoor  
 Miki Stephens  
 Paul and Rebecca Sterk  
 Don and Shirley Stevens  
 Stewart Education Foundation  
 Lynelle Stoddard  
 Liz Stone  
 Alan and Paige Stotts  
 Kevin Strait and Sarah Ilstrup  
 Jeff Streba and Molly Lewis  
 Fred and Linda Strohacker  
 James Stuart and Tammy Metz  
 Wes and Nola Sundquist  
 Alison Looney-Swillinger and Adam Swillinger  
 Mike and Leslie Tate  
 Bill and Linda Tatomer  
 Kate Taylor and Molly Richardson  
 Matthew and Nancy Taylor  
 Gus and Elaine Teseros  
 The Dorsey & Whitney Foundation  
 The Thomas & William Gilbane Foundation  
 The Williams Companies, Inc.  
 Mark and Christine Thomas  
 Bill and Joan Thompson  
 Lee Thomsen and Julie Checkoway  
 Thomson Reuters  
 Thomas and Marcia Ticer  
 Ann Till  
 Sarah Tobin

Robert and Tami Tokita  
 Richard and Angela Tooze  
 Larry and Ellen Toscano  
 Teresa Totorica  
 Jerry and Lisa Treiman  
 Jim and Missy Tschabrun  
 Wayne and Linda Tyler  
 Michael and Kirsten Uchitel  
 Carolyn Uhle  
 Alex and Sally Uhle  
 Laurie Underwood  
 United Technologies  
 Lincoln Ure and Maureen O'Hara Ure  
 Peter and Leidy van Ispelen  
 Todd and Kristin VanOrman  
 Jamie Veghte  
 David and Barbara Viskochil  
 David Vitek and Jessica Arbogast  
 Charles and Ethanne Waldo  
 Haibo Wang and Jun Lu  
 Ken Ward and Pam Farrington  
 Brent and Jodie Ward  
 Jack and Sarah Warmath  
 Christian Waters and Kelly Henderson  
 Robert and Susan Webster  
 Kirk and Marilyn Wessel  
 Rob Westermann and Ellen Guthrie  
 David and Joy Lynn Wetzel  
 Rick and Kim Whatley  
 Chuck White  
 Carrie White

Willard L. Eccles Charitable Foundation  
 Jay and Lisa Williams  
 Cindy Willis  
 Doug and Kris Willmore  
 Rob Wilson and Elizabeth Howard  
 Phillip and Beckie Winston  
 Jeff and Michelle Wolchok  
 Doug Wortham and Nick Nero  
 Julie Wrathall  
 Jason and Mary Rose Young  
 Kevin and Whysper Young  
 Everett Young  
 Sarah Young  
 Jeff and Ivy Zawalski Zawalski  
 Ted Zeitler  
 Robert Zeng and Bin Lin  
 Jay Zhang and Haiying Lu  
 Imran and Dorothy Zubair

Margaret Boothby Gwinn '41  
 Marilyn Nelson Kelso '43  
 Janet Ossman Minden '43  
 Bette Jeanne Decker Sage '43  
 and James Sage  
 Beverly Black Kauffman '44  
 Patricia Pearsall Hartman '45  
 Geraldine Ossman Farber '47  
 Eve Dahnken Krayenbuhl '47  
 and Bernard Krayenbuhl  
 Nancy Tisdal Miles '47  
 and Lowell Miles  
 Patricia Coli Roschen '49  
 and John Roschen

### 1950's

Anne Carter Hopkin '50  
 and John Hopkin  
 Joan Bennett Firmage '51  
 and John Firmage  
 Cynthia Muirhead Worthington '51  
 Eleanor Goeltz Anderson '54  
 and Paul Anderson  
 Roberta Jenkins '54  
 Constance Rouillard McGowan '55  
 and Dick McGowan  
 Stephanie Deck Jackel '56  
 Virginia Sweet Pringle '56  
 Elizabeth Fink Hecht '57  
 and Mervyn Hecht  
 Bette Bennett Penney '57

### ALUMNI & FORMER STUDENT DONORS

#### 1930's

Betsy Parrish Berry '36  
 Marion Alexander Peterson '36  
 and Pete Peterson

#### 1940's

Katharine Wright Lamb '40  
 Louise Winger Yeates '40  
 and Jack Yeates  
 Virginia Hutchinson Dean '41



and Donald Penney  
Josephine Ray Hunt '58  
and E.K. Hunt  
Elizabeth Doerr Totten '58  
and Dick Totten  
Florence Haines Frucher '59  
and Sandy Frucher  
Joan Schwartz Hodge '59  
and John Hodge  
Meredith McManus '59

### 1960's

Joan Friedman Pratt '60  
Sally Adams Prinster '60  
Ellie Olwell Roser '60  
and John Roser  
Daniel Schwartz '61  
and Theresa Schwartz  
J. Donald Smith '61  
Carol Olwell '62  
Bill Atwood '63  
and Judith Atwood  
William Gibbons '63  
and Barbara Gibbons  
Thalia Papanikolas Smart '63  
and Allan Smart  
Leslie Spear Stone '63  
William Yaggy '63  
and Amy Leveen  
Genevieve Atwood '64  
and Don Mabey  
Ingrid Stalheim Andrews '65  
and Richard Andrews  
Suzanne Sweazy Blue '66  
Frank Atwood '67  
Vicky Gibbons Hoagland '67  
and John Hoagland  
Jane Little Snider '68  
and Sam Snider  
Valli Gibbons Durham '69  
and Steve Durham

### 1970's

John Roberson '70  
Deborah King Cobo '71  
and Juan Cobo  
Frances Hartogh '73  
Rebecca Tribe '73  
Anne Worthington '73  
Allen Organick '74  
Susan Dalglish Kernan '78

### 1980's

Christy Cornell Kunin '80  
and John Kunin  
Tory Magleby '84  
and James Magleby  
Kristi Terzian Cumming '85  
and John Cumming  
Bronwen Calver '86  
Cory Lane '87  
and Sarah Lane  
Sara Anne Williams Spalding '87  
and Robert Spalding  
Gregory Ward '87  
Marina Condas Gianoulis '88  
and Tony Gianoulis  
Rachel Sweet Martin '88  
and Scott Martin  
Sarah Culp Cusumano '89  
and Mark Cusumano  
Jennifer Beck Lair '89  
and John Lair  
Ben Smith '89  
and Lindsey Oswald Smith '92  
Amy Hoepfner Taylor '89  
and Ryan Taylor

### 1990's

Rachel Kulmer Burnett '90  
and Matthew Burnett  
Kelly Hannah '90  
and Jennifer Bone Hannah '89  
Wood Moyle '90  
and Marianne Woolsey Moyle  
Matthew Rogers '90  
Heather VanDeventer '90  
and David Gortner  
Heather Ure Dunagan '91  
and John Dunagan  
Grace Kong '91  
Jesse Lowe '91  
and Whitney Lowe  
Kitty Northrop Friedman '91  
and Peter Friedman  
Christopher Swindle '91  
and Kathy Swindle  
Ben Dahl '92  
and Erica Dahl  
Mark Kulmer '92  
and Alison Farbman Kulmer '93  
Libby Mitchell '92



*Dawn Houghton and Mary Lawlor*

and Ryan Hoglund  
Rebecca Moyle '92  
Reagan Tolboe '92  
Ari Benowitz '93  
and Carrie Benowitz  
Jennifer Nakao Kawabata '93  
and Landon Kawabata  
Dustin Silvester '93  
and Jennifer Silvester  
Alison Kaminer-Berlin '94  
Christy Meade Olivier '94  
Geoff Swindle '94  
and Adria Muir Swindle '95  
Robert Lonergan '95  
Kendall Sumner Burwell '96  
and Stead Burwell  
Tracy Gibbons Llanos '96  
and Gabriel Llanos  
Tacy Conard Quinn '96  
and Brian Quinn  
Emily Barrett '97  
Jesse Keene '97  
and Jamie Wilhite  
Jennifer Ralph Oppold '97  
and Paul Oppold  
Christopher Von Maack '97  
and Alexandra Lee Von Maack '99  
Luke Muir '98

and Meredith Muir  
Sara Hames Warren '98  
and Kevin Warren  
John McIntosh '99  
Andrea Williams Polintan '99  
and Mark Polintan  
Kacie Tachiki '99

### 2000's

J.Z. Davis '00  
Nathaniel Kogan '00  
and Anna Battis  
Mary Lombardi '00  
Conor Bentley '01  
and Mary Anne Wetzel '01  
Elizabeth Biittner '03  
Kira DelMar '03  
Chase Dreyfous '03  
Molly McCarthy '03  
Sarah Hall '04  
Elizabeth Schackmann '04  
Dennis Tua'one '04  
Chelsea Webber '04  
David Wetzel '04  
Nathaniel Barusch '05  
Randall Crail '05  
Katy Mohrman '05  
Ashleigh Price '05

Kai Tohinaka '05  
Lindsey Adams '06  
Dana Pool '06  
Rosemary Tua'one '06  
Bianca Filion '07  
Michael Madlang '07  
Lita Madlang '08  
Jorgi Paul '08  
Kanika Tua'one '08  
Walker Adams '09  
Jacob Fuhrman '09  
Blake Harries '09

### 2010's

Andrew Arshat '10  
Griffin Gilbert '10  
Andrew Patterson '10

*\* Our apologies to Cindy Willis for neglecting to include her name in the 2008 - 2009 Annual Report.*

## IN MEMORY OF

George Baker  
Pat Brim '41  
Rose Deisley  
Eric Einersen '83  
Kaye Fillmore  
Richard Labov  
Al and Janet Smith  
Sutton Snook '90  
Dr. Robert Rees  
John Ringholtz  
Kelly Wells '99  
Russell Wherritt

## IN HONOR OF

Conor Bentley '01  
Shirley Collier  
Sarah Hall '04 and Brooks Hall '10  
Olle Larsson  
Gail Sanders

## GRANDPARENT DONORS

*Current Rowland Hall grandchildren are listed*

**Dr. Nina Allen**  
Eileen Hopf  
**Ms. Diane H. Anderson**  
Sophie Uchitel, Jack Uchitel, Sasha Uchitel  
**Mr. and Mrs. Norman Anderson**  
Leonie Anderson, Livia Anderson, Josie Anderson  
**Ms. Ilona Anderson**  
Caelum van Ispelen  
**Mr. and Mrs. Richard Badenhausen**  
Liza Badenhausen, Will Badenhausen  
**Mr. and Mrs. Robert Bagdasarian**  
Andy Merrill, Louise Rech, Amelia Merrill,  
Charly Rech, Zachary Merrill  
**Mr. and Mrs. Leonard Baker**  
Lane Baker, Bryce Baker  
**Mr. and Mrs. Robert Baker**  
Caroline Purcell, Charlie Purcell  
**Ms. Joan Ban**  
Jade Cole, Joshua Cole  
**Ms. Irene Baptista**  
Hailey Stephens, Kienna Stephens  
**Mr. Robert Barbanell**  
Calvin Barbanell, Zach Barbanell  
**Mr. Roland Barbero**  
Tatum Brown-Barbero, Ellison Brown-Barbero  
**Mr. and Mrs. Robert Batal**  
Alex Fort, Haley Fort

**Mr. and Mrs. Joe Bennett**  
Blair Alley  
**Mr. and Mrs. Don Berg**  
Jordan Ruga  
**Mrs. Dale O. Berry**  
Nick Orfanakis, Emilie Orfanakis  
**Mrs. Roberta Bocoock**  
Elisabeth Bocoock, Mary Bocoock, Jimmy  
Bocoock, Scottie Bocoock  
**Mr. and Mrs. Jesse C. Bown**  
Auden Bown  
**Mr. and Mrs. Pierce Browne**  
Lily Ferguson  
**Mr. and Mrs. Murray Campbell**  
Anna Shott, Blake Shott  
**Mr. and Mrs. Scott Carlin**  
Emma Carlin  
**Mr. and Mrs. Gerald K. Carlisle**  
Nate Carlisle, Iris Masaryk  
**Mr. and Mrs. Larry Carlson**  
Seth Carlson  
**Mrs. Anita Catron**  
Nick Orfanakis, Emilie Orfanakis  
**Mr. Otis Charles**  
Jake Wilkinson  
**Mr. and Mrs. James Clayton**  
Sara Swenson, Scout Swenson  
**Ms. Dorothy Curtis**  
Eileen Hopf  
**Mrs. Jean Czajkowski**  
Abeni Czajkowski  
**Mr. Jack D. Smith and Mrs. Abby Dalton**  
Jack Smith  
**Mr. and Mrs. Peter Diamandis**  
Sasha Diamandis, Skylar Diamandis  
**Mr. and Mrs. Carl DiBella**  
Emily DiBella  
**Mr. Duane Duernberger**  
Ross Cooper  
**Mr. and Mrs. Steve Durham**  
Lilli Durham  
**Ms. Linda Easley**  
Hailee Eesley  
**Ms. Gail Flanagan**  
Owen Keil, Maddie Keil  
**Mr. John F. Fort III**  
Alex Fort, Haley Fort  
**Mr. and Mrs. Hugh Fowler**  
Benjamin Fowler, Emily Fowler  
**Mr. and Mrs. Gregory Frech**  
Maddy Frech

**Mr. and Mrs. Carroll Freeman**  
Christine Livsey  
**Mr. and Mrs. Bernard Fuhrman**  
Eli Fuhrman  
**Ms. Beth Gibson**  
Cooper Davis  
**Mr. and Mrs. Gerald E. Glasgow**  
Garrett Glasgow, Sommer Glasgow,  
Matthew Glasgow  
**Ms. Marie Graham**  
Julia Graham, Ian Graham, Theo  
Graham  
**Mr. and Mrs. Don Granberg**  
Macy Olivera  
**Ms. Frances C. Groneman**  
Leonie Anderson, Livia Anderson, Josie  
Anderson  
**Mr. Thomas Hadinger**  
Jack Attridge  
**Mr. and Mrs. John T. Hamamoto**  
Ryan Collier  
**Mr. and Mrs. Timothy Hanson**  
Nate Satovick  
**Mr. and Mrs. Leon Harrison**  
Chase Kroesche

**Mr. and Mrs. Phil Horsley**  
Mei Mei Johnson, Teddy Johnson, Tanner  
Johnson  
**Mr. and Mrs. Ray Huelskamp**  
Charlie Huelskamp, Sonia Rubinfeld  
**Ms. Lorraine Jensen**  
Alyssa Jorgensen  
**Ms. Cynthia Johnson**  
Kate Warren, Will Warren  
**Mr. and Mrs. Steven C. Johnson**  
Cate Christiansen, Adie Christiansen  
**Mr. and Mrs. Steve Keat**  
Emmy Dichter, Stiles Dichter  
**Mr. Jeff Keil**  
Owen Keil, Maddie Keil  
**Mrs. Retta L. Keil**  
Owen Keil, Maddie Keil  
**Dr. and Mrs. Melvyn Klein**  
Xander Klein, Zachary Klein  
**Mr. and Mrs. George Kramer**  
Devon, Dee Tonneson, Izzy, Isabel Tonneson  
**Mr. Ralph Kroescher**  
Chase Kroesche  
**Mr. and Mrs. James B. Lee**  
Ian Christiansen, Rachel Christiansen



*David and Romy Cohen*

**Ms. Bea Lehman**  
Tyler Lehman, Will Lehman, Samantha Lehman  
**Ms. Janet Lewis**  
Gracie Lewis  
**Ms. Susan P. Lewis**  
Lydia Geyer  
**Ms. Dorothy Love**  
Carter Cichos  
**Mr. and Mrs. Thomas P. Lowe**  
Jess Sterrett, Sage Sterrett  
**Mr. and Mrs. Henry Maimon**  
Benjamin Smith, Sam Smith  
**Ms. and Ms. Tami Marquardt**  
Briggs Ballard, Boston Ballard  
**Mr. and Mrs. Spencer Martin**  
Ellie Martin, Perry Martin  
**Ms. Colleen A. Martin**  
Franz Long, Hazel Long  
**Ms. Miyoshi Marumoto**  
Allison Mayetani  
**Mrs. Norma W. Matheson**  
Will Matheson  
**Ms. Beatrice Mayetani**  
Allison Mayetani  
**Ms. Mary Ellen McCormick**  
Charlie Tate, Marguerite Tate  
**Mr. and Mrs. Robert Mellor**  
Ian Mellor, Wynn Mellor  
**Mr. Se H. Mendenhall**  
Imani Mendenhall  
**Mrs. Penny Merrill**  
Andy Merrill, Amelia Merrill, Zachary Merrill  
**Mr. and Mrs. Paul Metzger**  
Maya Rabbitt, Sydney Rabbitt  
**Mr. and Mrs. James R. Michie Sr.**  
Lochlin Michie, Daphne Michie  
**Dr. Jon Middleton**  
Samantha Baneth, Madeleine Baneth  
**Mr. Harold E. Miller Jr.**  
Reece Miller  
**Mr. and Mrs. Rolando Miranda**  
Alessandra Miranda  
**Mr. and Mrs. David Mize**  
Shelby Porges, Davis Porges, Taylor Porges  
**Mr. and Mrs. Owen A. Moran**  
Ryan Graves, Jake Graves  
**Mr. and Mrs. Jiro Mori**  
Josef Sueoka, Maxwell Sueoka  
**Dr. Gary Nakao and Mrs. Stephanie Mori-Nakao**  
Carson Kawabata  
**Mr. Clyde F. Nelson**  
Rachel Nelson, Connor Nelson

**Mr. and Mrs. William F. Nielsen**  
Sophia Nielsen, Caroline Nielsen  
**Mr. and Mrs. Toto Olivera**  
Macy Olivera  
**Ms. Susan Olszanskyj**  
Greg Olszanskyj  
**Ms. Martha Paige**  
Anna Hull  
**Dr. David Paisley**  
Heidi Paisley, Samantha Paisley  
**Mr. and Mrs. Joe Palmer**  
Ella Peterson  
**Mr. and Mrs. Jaeyoon Park**  
Andrew Yang  
**Mr. and Mrs. Leroy Parkin**  
T. J. Pope  
**Dr. and Mrs. Jeffrey Peters**  
Stella Peters  
**Mr. and Mrs. Bill Petzold**  
Heidi Paisley, Samantha Paisley  
**Mr. and Mrs. Raj K. Puri**  
Alison Puri, Amber Puri  
**Mr. and Mrs. Frank Putman**  
Lucy Putman  
**Ms. Marcia Richards**  
Greg Olszanskyj  
**Dr. Wallace Ring**  
Olivia Filion  
**Mr. and Mrs. Howard Rinn**  
Hayden Rinn  
**Mr. and Mrs. Michael D. Rollins**  
Olivia Rollins, Tripp Rollins  
**Mr. and Mrs. Leon Royer**  
Maya Royer  
**Mr. and Mrs. Seymour Rubinfeld**  
Sonia Rubinfeld  
**Ms. Ivy Ruckman**  
Ellis Ruckman  
**Ms. Sandra Schawelson**  
Jackson Byck, Max Byck  
**Mr. and Mrs. Jack Schiefer**  
Milo Hunter  
**Mr. and Mrs. Wolfgang Schlemmer**  
Natasha Fisher  
**Mr. and Mrs. Fred Schwab**  
Zachary Schwab, Alexa Schwab  
**Mrs. and Mr. Minor Shaw**  
Bo Lowrance, Tom Lowrance  
**Mr. and Mrs. Gary Shirkey**  
Deja Shirkey, Branden Lawyer  
**Mr. Rich and Dr. Mary-Ann Simon**  
Eli Hatton

**Mr. and Mrs. Allan Smart**  
Max Smart, Leo Smart  
**Mr. and Mrs. Nick Smith**  
Lochlin Michie, Daphne Michie  
**Mrs. Marilyn Snow**  
Olivia Prosper  
**Mr. and Mrs. Ted G. Solomon**  
Zeke Bradley, Nick Bradley  
**Mr. and Mrs. Mark Squiers**  
Garrett Glasgow, Sommer Glasgow, Matthew Glasgow  
**Dr. and Mrs. Melvin Steinhart**  
Ben Amiel, Joey Amiel  
**Mr. and Mrs. Lewis Stone**  
Chase Kroesche  
**Mrs. Catherine O. Stone**  
William Stone, Harry Stone  
**Mr. Paul Stotts**  
Erin Stotts, Hayden Stotts  
**Mr. and Mrs. Joe Sueoka**  
Josef Sueoka, Maxwell Sueoka  
**Mr. and Mrs. Stephen Swindle**  
Ella Swindle, Lilly Swindle  
**Mr. and Mrs. Henry Takei**  
Arden Louchheim, Carter Louchheim  
**Mr. and Mrs. Charles Thomas**  
Becca Glazier, Jena Glazier  
**Mr. and Mrs. George Thomsen**  
Sophie Thomsen, Abby Thomsen  
**Mr. and Mrs. George Thorne**  
Milo Thorne, Cassidy Clark  
**Mr. and Mrs. Lawrence Trujillo**  
Heather Ernst  
**Mr. and Mrs. Thomas Turnbull**  
Emily Barron  
**Mr. and Mrs. Dave Wade**  
Doug Labov, Tyler Labov  
**Dr. and Mrs. Richard D. Wallin**  
Lucy Wallin  
**Mr. Mike Warren**  
Kate Warren, Will Warren  
**Ms. Susan Whereat**  
Ian Mellor, Wynn Mellor  
**Mr. Kenneth Willis**  
Micah Willis  
**Mrs. Lorraine Willis**  
Micah Willis  
**Mrs. Peg Wise**  
Alex Beaufort  
**Mr. and Mrs. Tony Yarlett**  
Molly McNamara, Will McNamara

## ONCE IN A BLUE MOON AUCTION 2010

A Gallery Frames, Inc.  
Aaron Bittner  
ACP Mac  
Adrienne and John McNamara  
Alan and Margie Coombs  
Alan Sparrow  
ALANA-TOKAJ Winery  
Albert Chloe, Chloe Preble '09  
Alex Bocock and Amy Sullivan  
Alex Stein Designs, Alexa DuBois  
Amy and Barry Baker  
Andrei and Masha Kirilenko  
Angela Keen MD, PLLC, Plastic and Reconstructive Surgery  
Angela Martindale of Transform  
Angela Tooze  
Animal Care Center, Dr. Pam Nichols  
Animal Health Options, Dr. Kim Henneman '78  
Anne and Brent Baranko  
Anthony's Pets  
Apple Inc.  
Apt. 202, Ashley Rothwell Campagna '95  
APTitude Academics  
Arella Pizzeria  
Arlene Sosnowski Skin Renewal Center  
Artistic Endeavors  
Ashley and Troy Holbrook  
Aspen Falls Spinal Care Center  
Athletic Republic, Charlie and Linda Graves  
Atomic Ski Company  
Avatar Design Group  
Avenues Yoga and Mandi Jensen  
Ballet West  
Bar Lazy J Guest Ranch  
Barclay Butera, Inc. Design Service  
Bart and Georgia Reuling  
Bastille, Jason and Dawn Farrell  
Be Amazing Toys  
Bella Donna Designs  
Bellavie Boutique  
Ben and Lisa Logue  
Big Sky Resort  
Bill and Deborah Zanker  
Bill and Rhonda Nicoloff  
Bill Demong  
Blazing Needles  
Bloomingsales, Steve and Sonnie Swindle  
Bob and Wendy Reed Steiner  
Bob Ithurralde, Foothill Barber  
Bob Marquardt  
Bouncin' Off The Walls  
Brett & Kay Christiansen

Brian Usher  
Broadway Across America - Utah  
Brooke F. Scott Photography  
Brooklyn Wilson, Furnishings Seamstress  
Bryan Stanley  
Bumps & Bundles Photography  
Busath Studio and Gardens  
Cactus & Tropicals  
Cafe Diablo  
Cafe Trio  
Cake Boutique  
Cameron Wellness Center  
Camp Lincoln/Camp Lake Hubert  
Candle Warmers Etc.  
Caputo's on 15th  
Carol and David Frymire  
Carol Wetzel  
Charley Hafen Jewelers & Gallery  
Charlotte's  
Chase Kroesche  
Chelsea Lately Show  
Chevron  
Choice Life Strategies  
Click Computers  
Coach Mike's Tennis Academy  
Cole Sport  
Color Me Mine Park City  
Color Me Mine Salt Lake  
Crossfit NRG  
Cucina Toscana  
Culinary Crafts  
D. Grant, LTD.  
Daniel Damico and Will Damico  
Dave and Becky Hall  
Dave Malone  
Dave Sidlow  
David and Akemi Louchheim  
David and Patricia Bradshaw  
Dawn Rodgers  
Dee and Colin Gardner  
Deer Valley Resort  
Dennis Uniform Manufacturing Company  
Discovery Gateway Children's Museum  
Dolly's Bookstore  
Doloris Petunia by Courtney Prince Miller '96  
Domus AV  
Don Brady Design  
Donna L. Milavetz, MD, MPH  
Donna McAleer  
Dorene Sambado and John Foley  
Dr. Sam Goldstein

Draper's Incredible Pizza Company  
Eagleridge Tennis & Swim Club  
Edge, Paul and Sarah Lehman  
Egyptian Theatre  
Elevation, LLC  
Emily and Gordon Smith  
Emily Cannon  
Emily Cannon  
Emily Jane Photography  
Epic Brewery, Dave and Susan Cole  
Erich and Celeste Flynn  
Erin Berrett  
Ethan and Kelly Fisher  
Evans Hardwood Flooring  
Fairmont Miramar Hotel & Bungalows  
Faye Mitsunaga and Jim Eng  
Filion Will Fix It, Michel Filion  
Finnish Touch Day Spa  
Finn's Cafe  
Firehouse BBQ  
Fit with Candice  
Four and Twenty Sailors  
Fresco  
Gail and Bob Sanders  
Geraldyn and Jim Dreyfous  
Glenwild Golf Club and Spa  
Golden Door Spa at the Dakota Mountain Lodge  
Granato's



*Caroline Milne, Eric Scaife, Julie Barbero*

Greene Manor Family Retreat  
 Gregory Jbarra  
 G-Star Raw  
 Gymnastics Training Center  
 Hal and Leslie Stone  
 Hammerton, Bill and Nancy Shott  
 Hannah and Grace Riter  
 Hapa Grill Park City - Sushi School  
 Happy Dragon Designs LLC  
 Harry Stone and William Stone  
 Haute Hostess, LLC  
 Heather and Shawn Johnson  
 Heber Valley Historic Railroad  
 Heidi and Tom Brickey  
 High West Distillery & Saloon  
 Hip & Humble  
 Hiram and Priya Chodosh  
 Hotel Vitale  
 Illumina Organics LLC  
 Imagination Place  
 Ira Rubinfeld and Willamarie Huelskamp  
 Jack and Darcy Amiel  
 Jack Whittle and Molly Whittle  
 James and Kris Dumas  
 James Macintyre and Liz Joy  
 James McNeil and Alison Stone  
 Janell James '93  
 Jason's Deli  
 Jennifer Nakao '93  
 Jerad and Ashley Park  
 Jill and David Lang  
 J LH Equestrian  
 JMR/Lolabella  
 Jocelyn and Alfred Lutter  
 Joe and Zoe Cunniff  
 John and Ardis Piers Foundation  
 John and Elizabeth Whittle  
 John and Kim Kircher  
 John Ballard and Karen Miller  
 John Bird and Rin Harris  
 Jon D. Williams Cotillions Inc.  
 Jordan Ruga  
 Josh Blumental, Photographer  
 Julie Shipman Photography  
 Jupiter Bowl, Amy and Barry Baker  
 JW Allen & Sons  
 K-9 Rehab Center  
 Kami Kahler  
 Kangaroo Zoo  
 Karen Martin  
 Kate Ferguson  
 Kate Holland Jewelry



*Adria Swindle, Ray Brim, and Libby Ellis*

Kathie and Mark Miller  
 Kathryn Czarnecki  
 Kathy's Couture  
 Kelly and Jeanene Patterson  
 Ken Garff Mercedes-Benz  
 Kim McFarland  
 Kimball Art Center  
 King's English Bookshop  
 Kura Door Holistic Japanese Spa, Mark Kulmer '92 and  
 Ali Farbman Kulmer '93  
 Kurt Larsen and Tyrene Christopulos  
 Kyoto Restaurant  
 La Caille  
 Lawrence and Beverly Sambado  
 Leslie Sutter and Sallee Robinson  
 Libby Ellis and Stuart Ruckman  
 Lindsay Alder Wojciechowski '93 and Steve  
 Wojciechowski  
 Lone Peak Designs  
 Lululemon  
 M Designs  
 M Lazy M Foundation, Mike and Muffy Ferro  
 MacCool's Public House  
 MacDocs Salt Lake City

Macy's Foundation  
 Malstrom Salon  
 Mandarin Restaurant  
 Margaret Hall and Jerry Lanchburg  
 Marianne Dischmann  
 Marina Riedel  
 Mark and Allison Paradise  
 Martine  
 Marva Match and Dianna Cannon  
 Mary Ciminelli  
 Maurine and Graydon Harker  
 MBody  
 Mehmet and Yeliz Okur  
 Metropolitan Restaurant  
 Michael Begue '85  
 Michele Christiansen  
 Mike and Karen Noble  
 Mike and Stephanie Orfanakis  
 Miller Motor Sportspark  
 Mini's Cupcakes  
 Momentum Recycling, John and Jennifer Beck Lair '89 and Jeff and  
 Kate Beck Whitbeck '92  
 Montage Deer Valley

Mountain City Appraisers  
 Mountain Medical Vein Center  
 Nailed!  
 National Abilities Center  
 Nile Eatmon  
 OC Tanner  
 Pago  
 Paisley Pomegranate  
 Paletti  
 Park City Cooking School  
 Park City Ice Arena  
 Park City Performing Arts Foundation  
 Patty Yun and Bobby Kwun  
 Paula Swaner Sargetakis and Joe Sargetakis  
 Peerless Beauty & Barber Supply  
 Peter and Margie Schloesser  
 Peter and Maryellyn Larcom  
 Peter Hayes  
 Philip and Sandy McCarthy  
 Pinon Market & Cafe  
 Planned Parenthood of Utah  
 Poise & Strength Pilates  
 Postfontaine  
 Prime Steak House  
 Promontory  
 Promontory Equestrian Center  
 Ragnar Events  
 REAL Salt Lake  
 Red Apple School Supply  
 Red Bull  
 Red Ledges  
 River Rock Lodge  
 Robin McCaul  
 Robin Puri  
 Rocket Web Design  
 Rockrecreation Climbing Gym  
 Roger and Karen Edgley  
 Rooster's Brewing Company  
 Roots Flower Shop  
 Rowland Hall Chess Club  
 Rowland Hall Grades K-12  
 Rowland Hall Online Store  
 Rowmark Ski Academy  
 Rudy and Fran Madlang  
 Russ Lyman  
 Ruth's Chris Steak House Salt Lake City  
 Salomon Center  
 Salomon USA  
 Salon MC

Salt Lake City Fire Department - Station 5  
 Salt Lake Swimming & Tennis Club  
 Sandlot Baseball and Fastpitch Academy  
 Sarah Hall  
 Savita Puri  
 Scales & Tails Utah  
 Scott and Connie Maves  
 Sew a la Mode  
 Shae and Alec Searl  
 Shelley Marshall  
 Shiso Sushi  
 Shoyu Sushi House and Japanese Kitchen  
 Skullcandy  
 SkyRidge Inn Bed & Breakfast  
 smARTspace Studio, Theresa Sueoka  
 Snowbird Ski Area  
 Snowed Inn Sleigh Company  
 So Cupcake  
 Spa Vitoria  
 Splendor Beauty Emporium

Sports Den  
 Spy Hop Productions  
 Squatter's Pub Brewery, Jeff and Susie Polychronis  
 St. Regis Deer Crest Resort  
 Starbucks  
 Stead and Kendall Sumner Burwell '96  
 Stephen Bennhoff  
 Steve and Michelle Lessnick  
 Steve Price and Ashleigh '05, Chelsea, Garrett,  
 Savannah,  
     and Jackson Price  
 Steven and Brenda Lowe  
 Streamline Bodyworks  
 Stuart Ruckman Photography  
 Sugar Buzz  
 Summerworks  
 Sundance Institute  
 Surface Medical Spas  
 Suzy Day  
 Sweet Candy Company, Rachel Sweet Martin '88



*Kim McGuire, Amy Sullivan, and Nancy McNally*

Tabula Rasa  
 Takashi  
 Tamra Hall  
 Taylor Design  
 Thanksgiving Point Golf Club  
 The Canyons  
 The Children's Hour  
 The Decorations Committee: Tina Ruga, Amy Damico  
 and Kendall Sumner Burwell '96  
 The Dr. Oz Show  
 The Equine Pavilion  
 The Five Alls Restaurant  
 The Fort Family  
 The Grand America Hotel  
 The Healthier Choice  
 The Jay Leno Show  
 The John and Marcia Price Family Foundation  
 The Late Late Show with Craig Ferguson  
 The Late Show with David Letterman  
 The Little Gym  
 The Lutter Family  
 The Old Spaghetti Factory  
 The Price-Wallin Girls - Hannah, Alexandra, and Lucy  
 The Rossignol Company  
 The Seethaler Family  
 The Veverka Family  
 Thorup Tutoring Co.  
 Threadheads  
 Tim Hogen  
 Tina and Jonathan Ruga  
 Tina Braun and Stan Freck  
 Tom Taylor  
 Tony Wallin and Jennifer Price-Wallin  
 Tonyburgers  
 Torino Jewelry  
 Tour of Utah  
 Tracy and LeiLani Fowler  
 TREK Travel, Jeff and Sharon Jonas  
 TriFecTa  
 Tulie Bakery  
 Tutoring Toy  
 U Continuing Education - Lifelong Learning  
 U Continuing Education - Youth Education  
 U-lys-ses Salon

Under the Eaves, Joe Pitti and Mark Chambers  
 Utah Animal Adoption Center  
 Utah Dog Park  
 Utah Museum of Natural History  
 Utah Olympic Park  
 Utah Ski and Golf  
 Victory Ranch  
 Vie Nouveau Salon and Day Spa  
 Vinto Pizzeria, David and Deborah Harries  
 Virginia Tanner Children's Dance Theatre  
 Visual Art Institute  
 Wade Laser Clinic  
 Ward & Child - The Garden Store  
 Wasatch Powderbird Guides  
 Wayne and Kathy Adams  
 Weinholtz Family Foundation  
 Westminster College Aviation Program  
 White Elephant Collective  
 X Logic Design, Ashley Park  
 Young Riders

**THE CAMPAIGN FOR ROWLAND HALL :  
 BUILDING THE FUTURE**

Anonymous (4)  
 Richard Badenhausen and Katherine Venti  
 Amy and Barry Baker  
 John Bird and Rin Harris  
 Priya and Hiram Chodosh  
 Tiffany and Rob Glasgow  
 Linda and Charlie Graves  
 Wally and Karen Jarman  
 John and Marcia Price Family Foundation  
 Guy and Carol Kroesche  
 Kurt Larsen and Tyrene Christopulos  
 Ben and Lisa Logue  
 The Mark and Kathie Miller Foundation  
 Rhonda and Bill Nicoloff  
 Phil and Sandy McCarthy  
 Margaret Niver McGann and Chris McGann  
 Kelly and Jeanene Patterson  
 Jennifer Price-Wallin and Tony Wallin  
 Robin and Raj Puri  
 Rowland Hall Class of 2010

Ira Rubinfeld and Willamarie Huelskamp  
 Ruth Eleanor Bamberger & John Ernest  
 Bamberger Memorial Foundation  
 Lawrence and Beverly Sambado  
 Helen Sandack  
 Saba Siddiqui and Faizi Siddiqi  
 Jania Sommers and Bob Deans  
 Steiner Foundation, Inc.  
 Bob and Wendy Steiner  
 Shari and C.J. Veverka  
 Mary Anne Wetzel

**Gifts to the Endowment**

Christine Brim and Thomas Blau  
 Katherine Brim  
 Ray Brim  
 Suzanne Day  
 Christopher and Laura Deisley  
 David Deisley  
 Ruth Deisley  
 The Malone Family Foundation  
 Bob Marquardt  
 Cecilia Straus  
 Tim and Jane Sullivan  
 J. Wherritt







# Rowland Hall

## MISSION

We inspire students to lead ethical and productive lives through a college preparatory program that promotes the pursuit of academic and personal excellence.

## VISION

Inspiring students who make a difference.

## VALUES

Inspiring a passion for life and learning.  
Our evolving curriculum encourages students to become enthusiastic and successful learners.

### **Striving for excellence**

Students thrive in an environment where challenge is expected, learning is supported, and personal best efforts are celebrated in class, on stage, and in athletics.

### **Fostering ethical development**

Rowland Hall values integrity and responsibility. We guide our students to make good choices and to learn from their mistakes.

### **Creating a diverse and inclusive community**

Rowland Hall encourages religious, ethnic, racial, and socio-economic diversity within its community and promotes understanding and acceptance of various cultures and points of view.

### **Nurturing a spirit of service**

Students develop a commitment to change their world for the better through an expansive service learning program.



# Rowland Hall

McCarthy Campus  
720 Guardsman Way  
Salt Lake City, Utah  
84108

Non-Profit Org.  
U.S. Postage  
**PAID**  
Salt Lake City, UT  
Permit No. 4324

## MISSION STATEMENT

Rowland Hall inspires students to lead productive and ethical lives through a college preparatory program that promotes the pursuit of academic and personal excellence.

[www.rowlandhall.org](http://www.rowlandhall.org)